

CONTROL POINT NO. 1	PK NAIL SET IN THE GUTTER	N 5039.31 E 9777.36 ELEV. 974.49
CONTROL POINT NO. 2	PK NAIL SET IN SIDEWALK	N 4928.81 E 9680.26 ELEV. 977.49
CONTROL POINT NO. 3	PK NAIL SET IN SIDEWALK	N 4883.51 E 9787.88 ELEV. 975.19
CONTROL POINT NO. 4	PK NAIL SET EDGE OF PAVE.	N 5084.54 E 9837.45 ELEV. 973.20
CONTROL POINT NO. 5	PK NAIL SET IN SIDEWALK	N 5075.49 E 9914.41 ELEV. 971.47

**UTILITY CONTACTS**

Mr. Doug Blanford (606) 271-7420  
GTE Telephone  
3725 Nicholasville Rd. Building No.2  
Lexington, Kentucky 40503

Mr. Raleigh Deaton (606) 275-7308  
Kentucky Utilities  
500 Stone Rd.  
Lexington, Kentucky 40503

Mr. Bryan Stone (606) 288-0289  
Columbia Gas  
2001 Mercer Road  
P.O. Box 14241  
Lexington, Kentucky 40512-4241

Mr. Raymond Gulley (606) 744-5832  
Columbia Gas Transmission  
P.O. Box 901  
Winchester, Kentucky 30391

Mr. Aubrey Cashman (606) 258-3468  
LFUCG Sanitary Sewer  
301 Liste Industrial Ave.  
Lexington, Kentucky 40511

Mr. Fred White (606) 268-6360  
Kentucky-American Water Company  
2300 Richmond Road  
Lexington, Kentucky 40502-1308

Before you dig call 1-800-752-6007  
or the individual utility companies  
to verify the locations of all utilities.

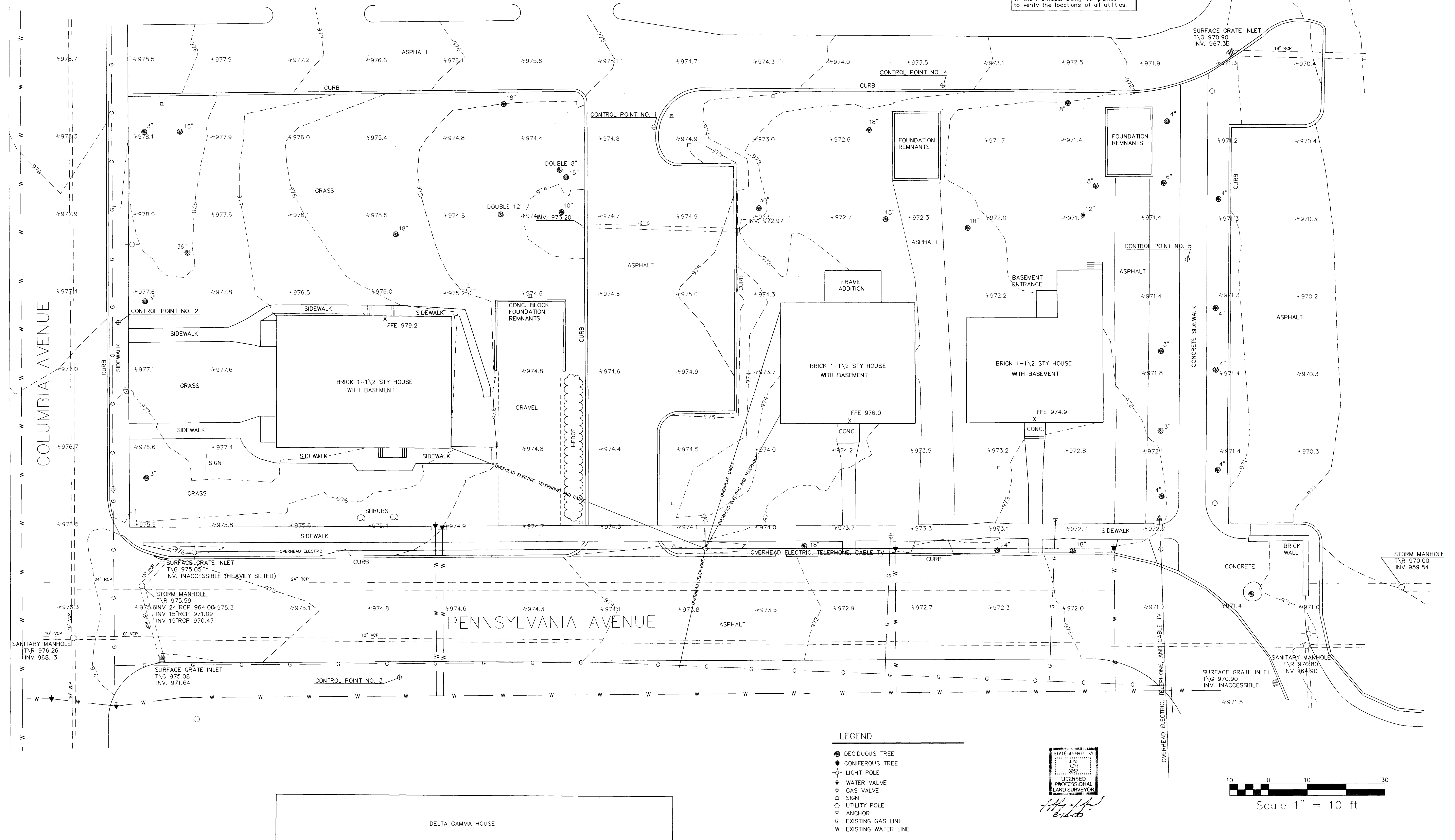

**LEGEND**

- DECIDUOUS TREE
- CONIFEROUS TREE
- LIGHT POLE
- ⊕ WATER VALVE
- ⊕ GAS VALVE
- SIGN
- UTILITY POLE
- ▽ ANCHOR
- G- EXISTING GAS LINE
- W- EXISTING WATER LINE

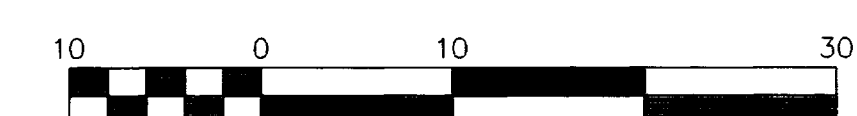
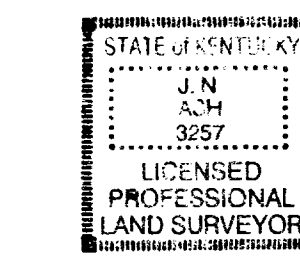

Scale 1" = 10 ft

**Quest Engineers, Inc.**  
310 W. Liberty Street  
Louisville, Kentucky  
502-584-6056

TOPOGRAPHIC SURVEY  
FOR  
UNIVERSITY OF KENTUCKY  
BUILDINGS NO. 0504 AND 0505  
LEXINGTON, KENTUCKY

SCALE: AS SHOWN  
DATE: 03/02/00  
JOB NO.:  
DESIGNED:  
DRAWN: TCM  
CHECKED: JNA  
G/C:  
OWNER APPROVAL:  
BY:  
TITLE:  
REVISIONS:  
NO. DATE:

DRAWING:  
**RO1**  
1 OF 1