

FIRST FLOOR PLAN MEDICAL OFFICE BUILDING (SAMARITAN)

18,031 Gross Square Ft.

DATE:
07-26-12
DRAWN BY:
FR

BLDG #:
0611

MEDICAL OFFICE BUILDING (SAMARITAN)
KEY DRAWING

UNIVERSITY OF KENTUCKY
Facilities Information Services

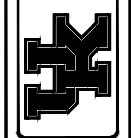

SHEET
1 OF 4

1/8/21 FB

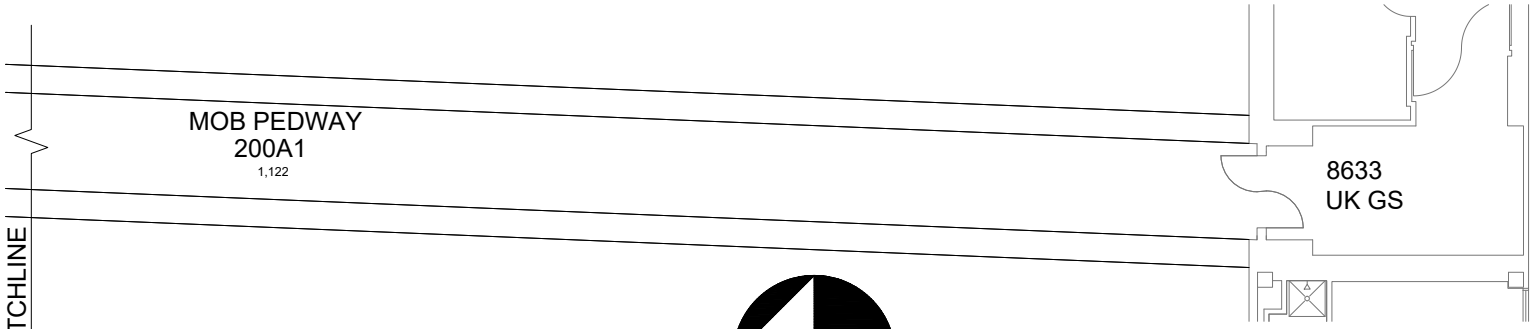
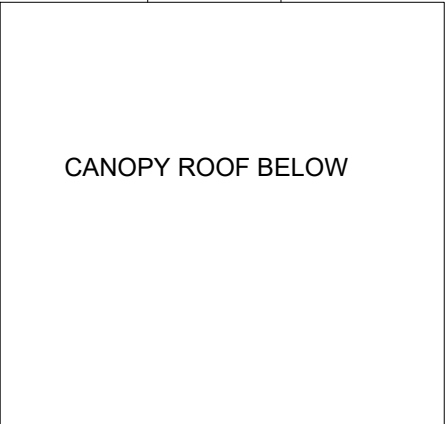
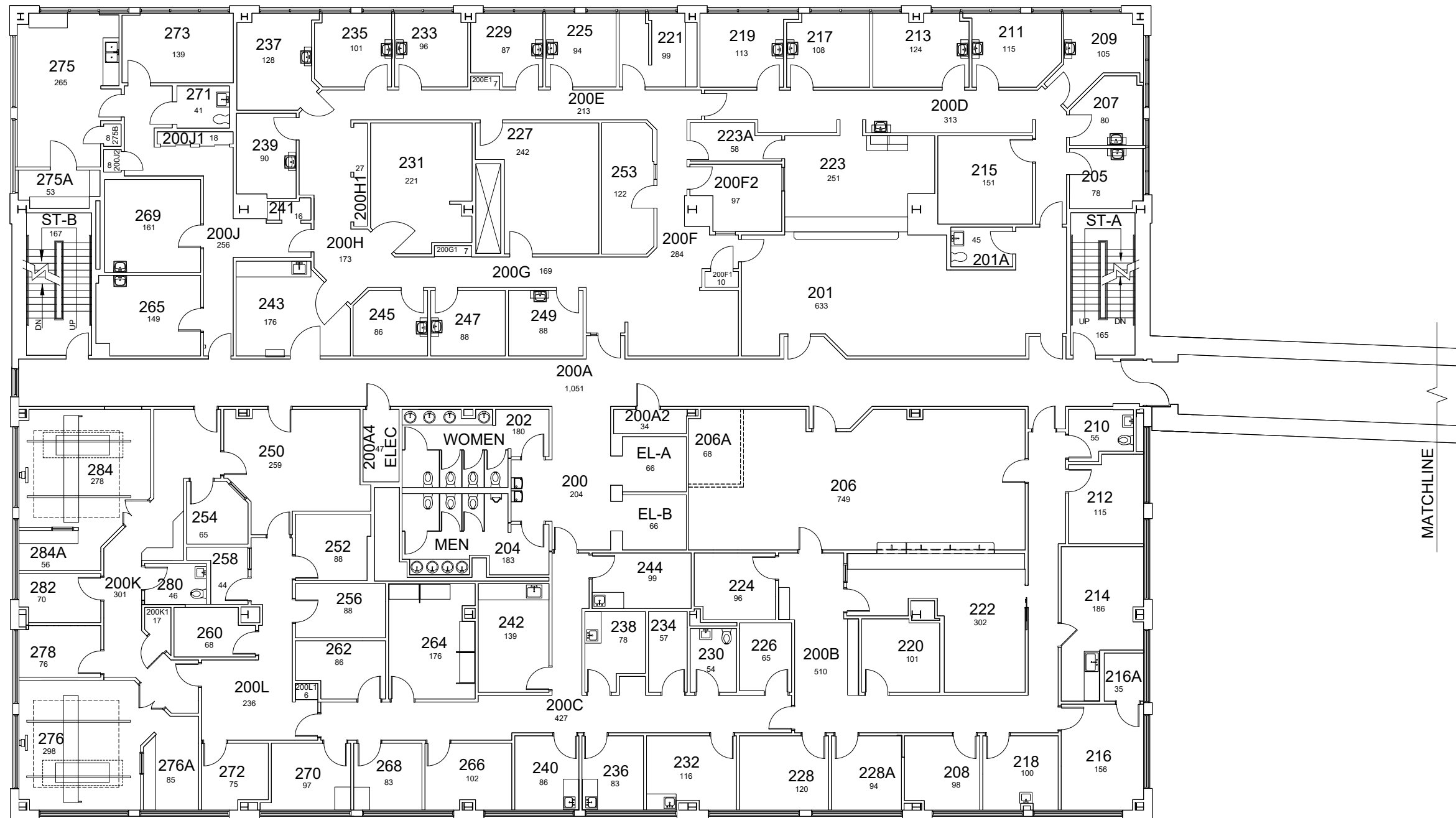

**SECOND FLOOR PLAN
MEDICAL OFFICE
BUILDING (SAMARITAN)**
18,322 Gross Square Ft.

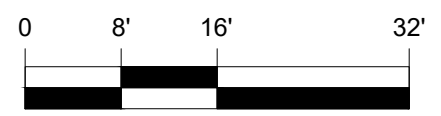

DATE:
07-26-12
DRAWN BY:
FR

BLDG #:
0611

MEDICAL OFFICE BUILDING (SAMARITAN)
KEY DRAWING

UNIVERSITY OF KENTUCKY
Facilities Information Services

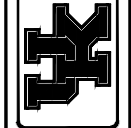

SHEET
2 OF 4

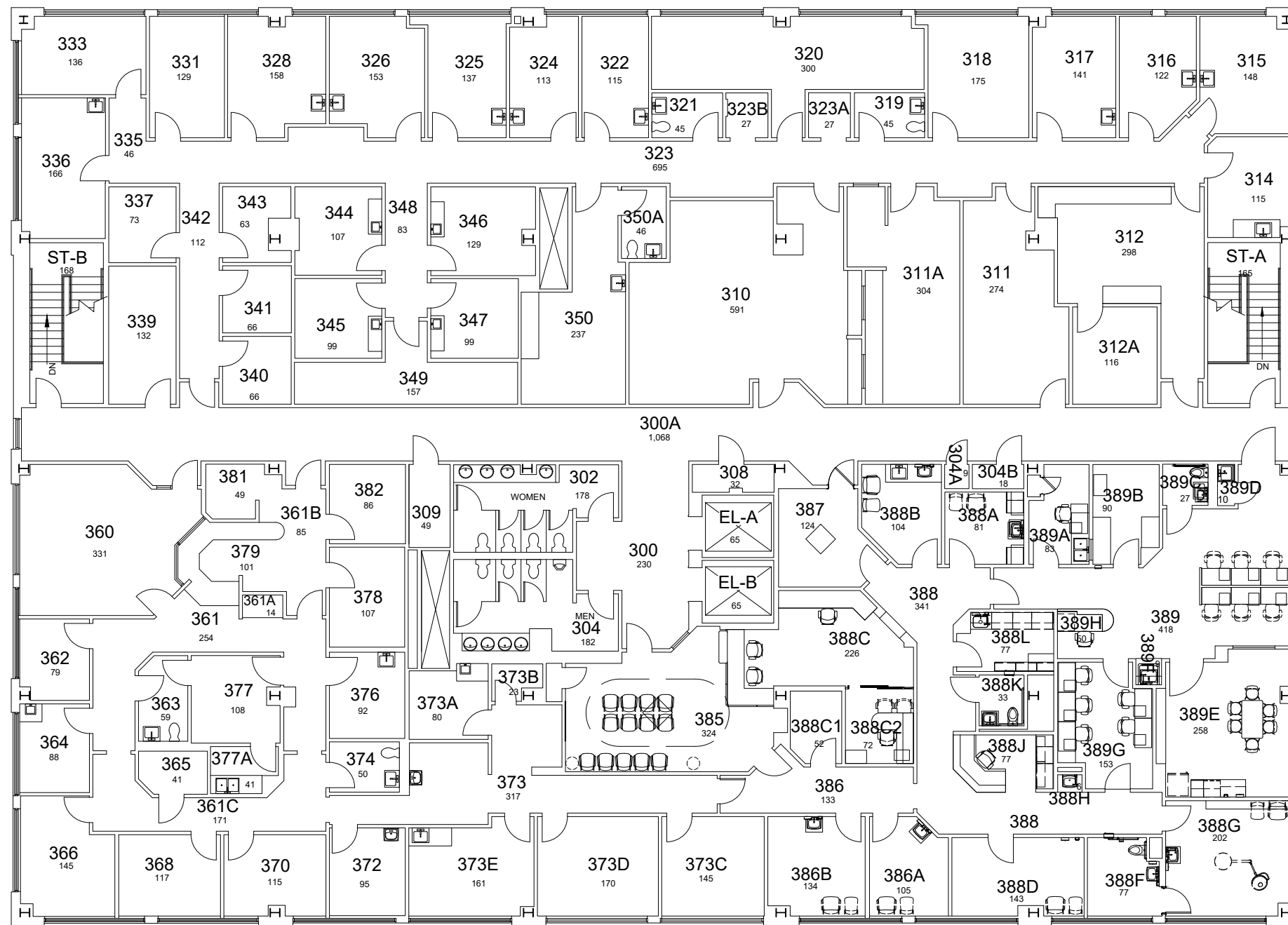

THIRD FLOOR PLAN MEDICAL OFFICE BUILDING (SAMARITAN)

16,576 Gross Square Ft.

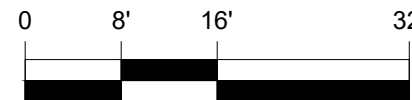

DATE:
07-26-12
DRAWN BY:
FR

BLDG #:
0611

MEDICAL OFFICE BUILDING (SAMARITAN)
KEY DRAWING

UNIVERSITY OF KENTUCKY
Facilities Information Services

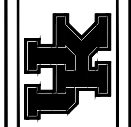

SHEET
3 OF 4

NFA 01/05/23

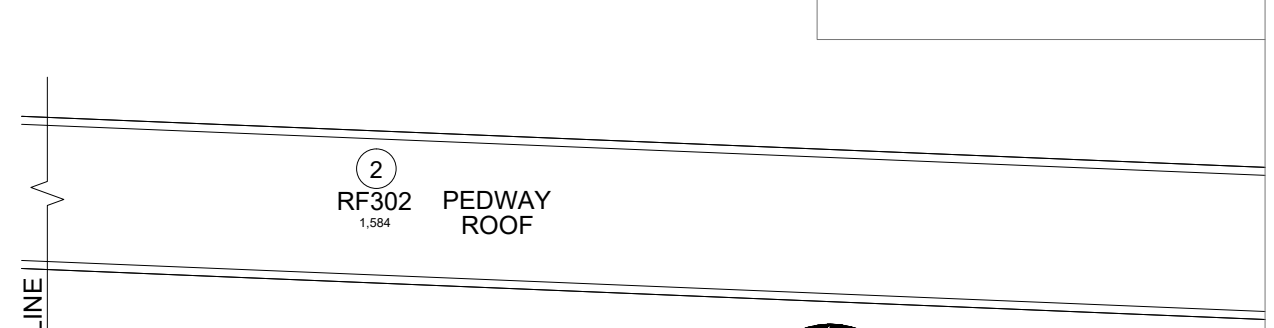
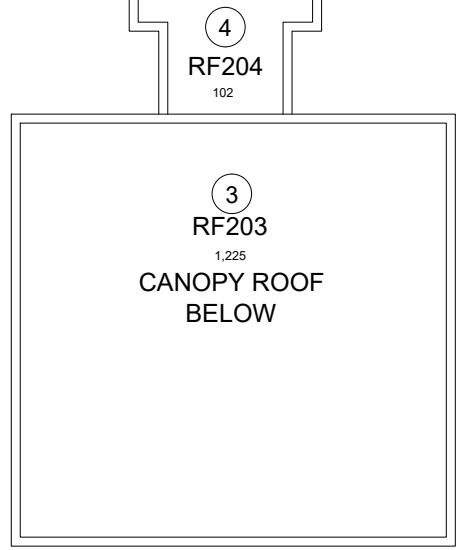
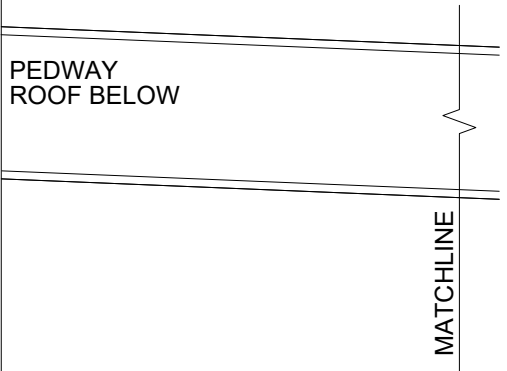
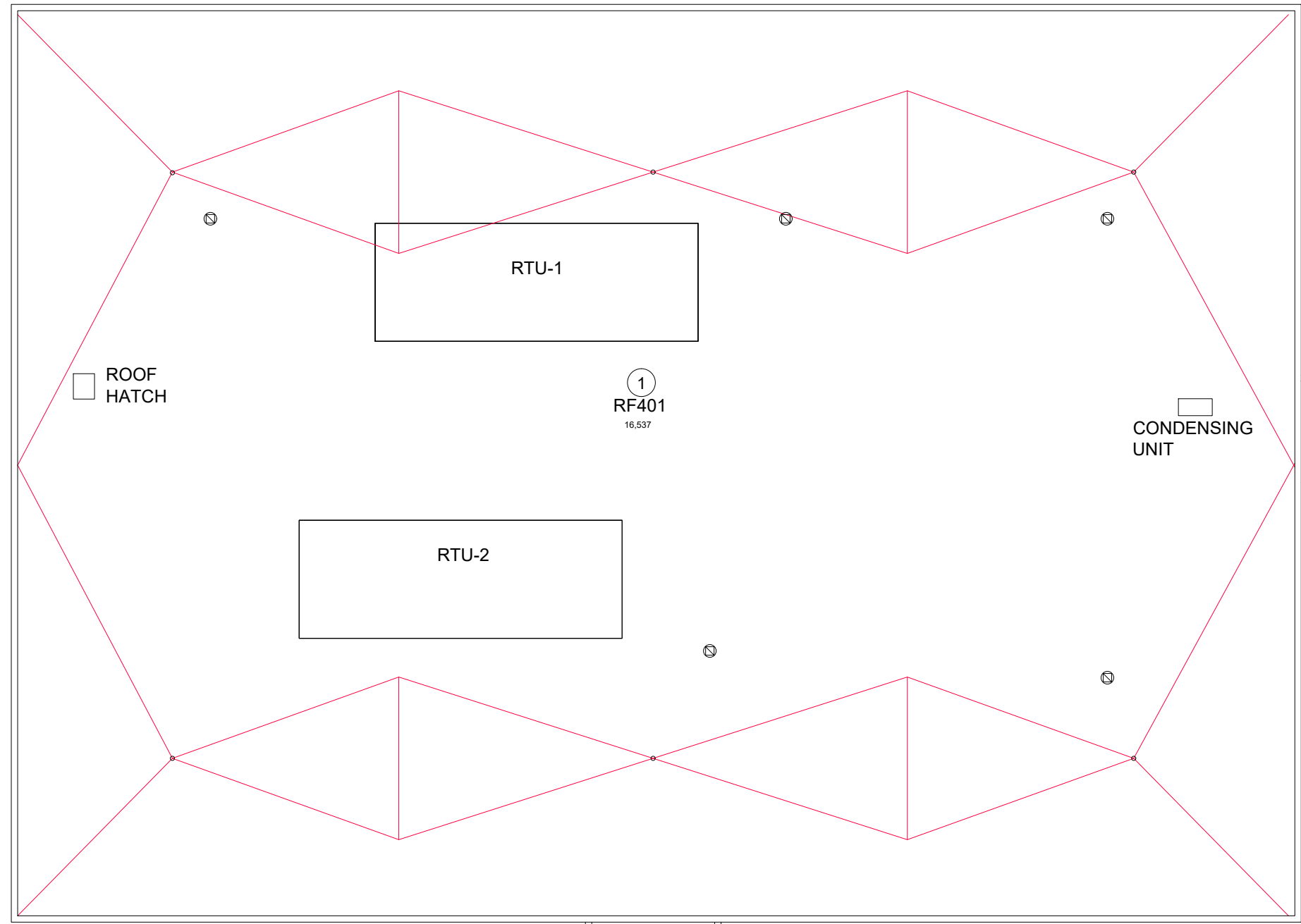
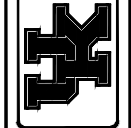

ROOF PLAN MEDICAL OFFICE BUILDING (SAMARITAN)

①
RF401
16,537

②
RF302
1,584
PEDWAY
ROOF

④
RF204
102

③
RF203
1,225
CANOPY ROOF
BELOW

8633
UK GS

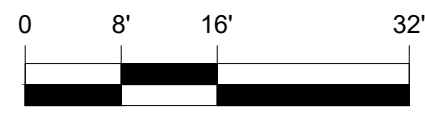

JES 11-11-15