

Floor plan is from best available information. Drawing will be updated as more information becomes available.

DATE: 09-23-12
DRAWN BY: FR

BLDG #: 0297

DENTAL SCIENCE BLDG
KEY DRAWING

UNIVERSITY OF KENTUCKY
ITS Information Services

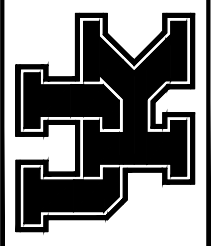

SHEET
1 of 9

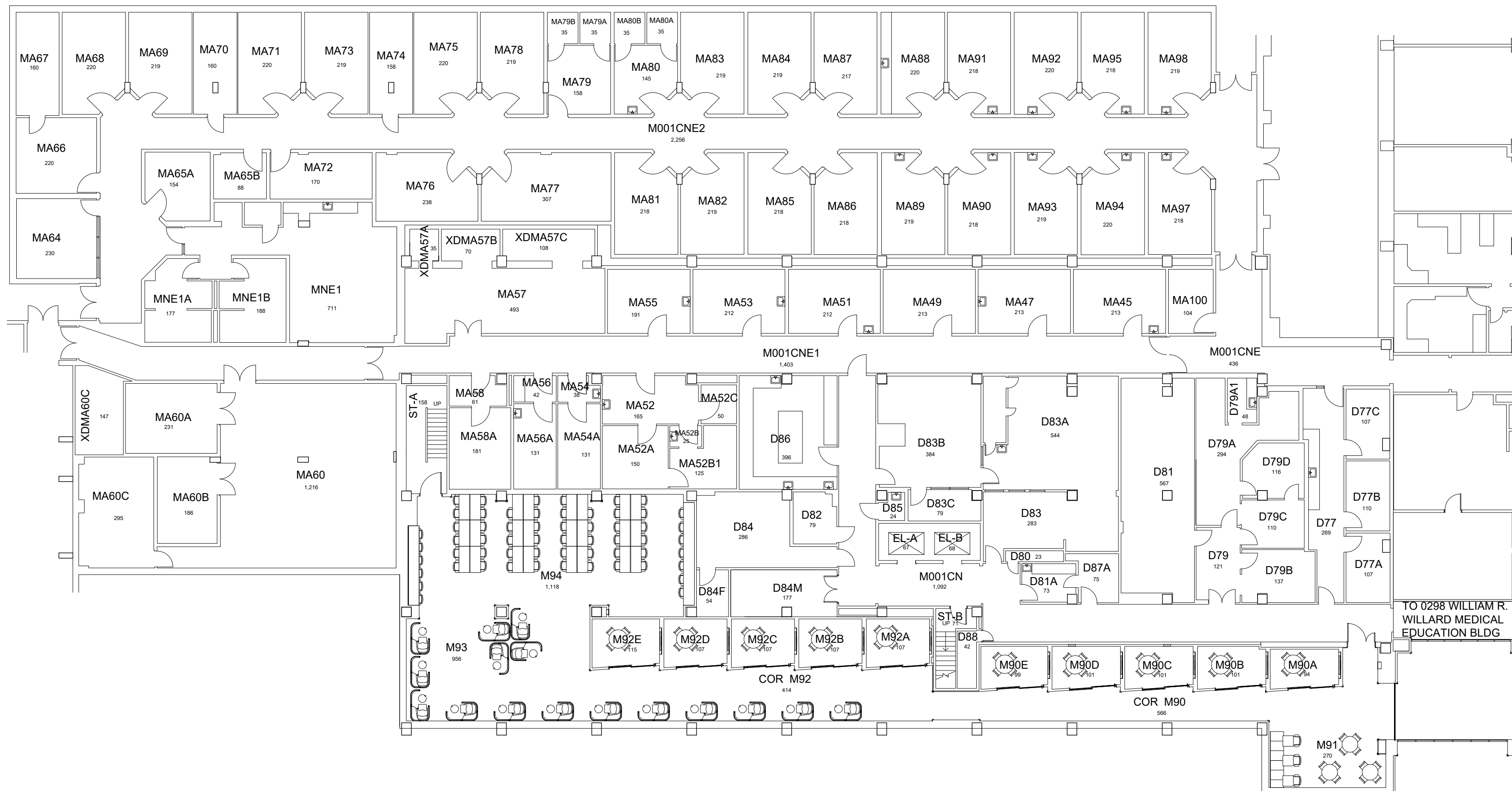

TO 0096 COMBS

TO 0298 WILLIAM R. WILLARD MEDICAL EDUCATION BLDG

FOR ENTIRE MEDICAL CENTER LIBRARY IN 0297 & 0298 SEE BUILDING NUMBER 0298 GROUND LEVEL PLAN

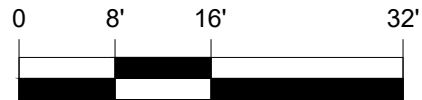

BASEMENT FLOOR PLAN DENTAL SCIENCE BUILDING

31,362 Gross Square Ft.

06-11-2018

NEK

DENTAL SCIENCE BLDG
KEY DRAWING

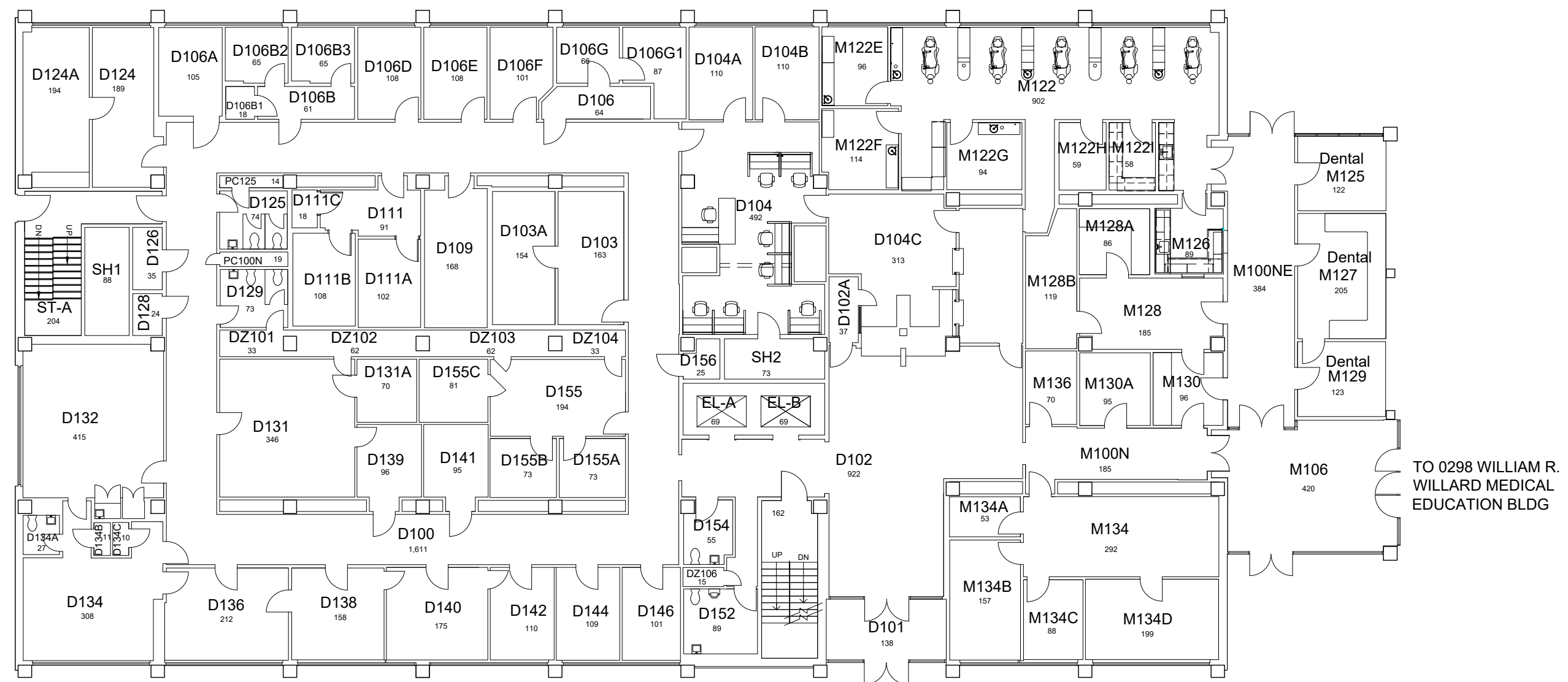
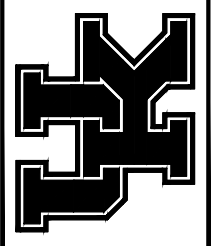

FIRST FLOOR PLAN
DENTAL SCIENCE BUILDING
15,825 Gross Square Ft.

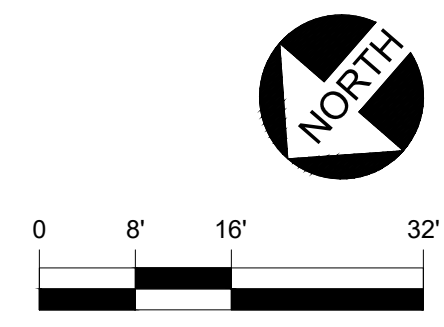

DATE: 09-23-12
DRAWN BY: FR

BLDG #: 0297

DENTAL SCIENCE BLDG

KEY DRAWING

UNIVERSITY OF KENTUCKY
ITS Information Services

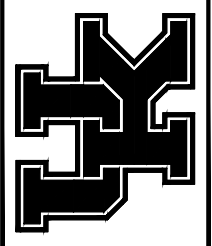

SHEET
3 of 9

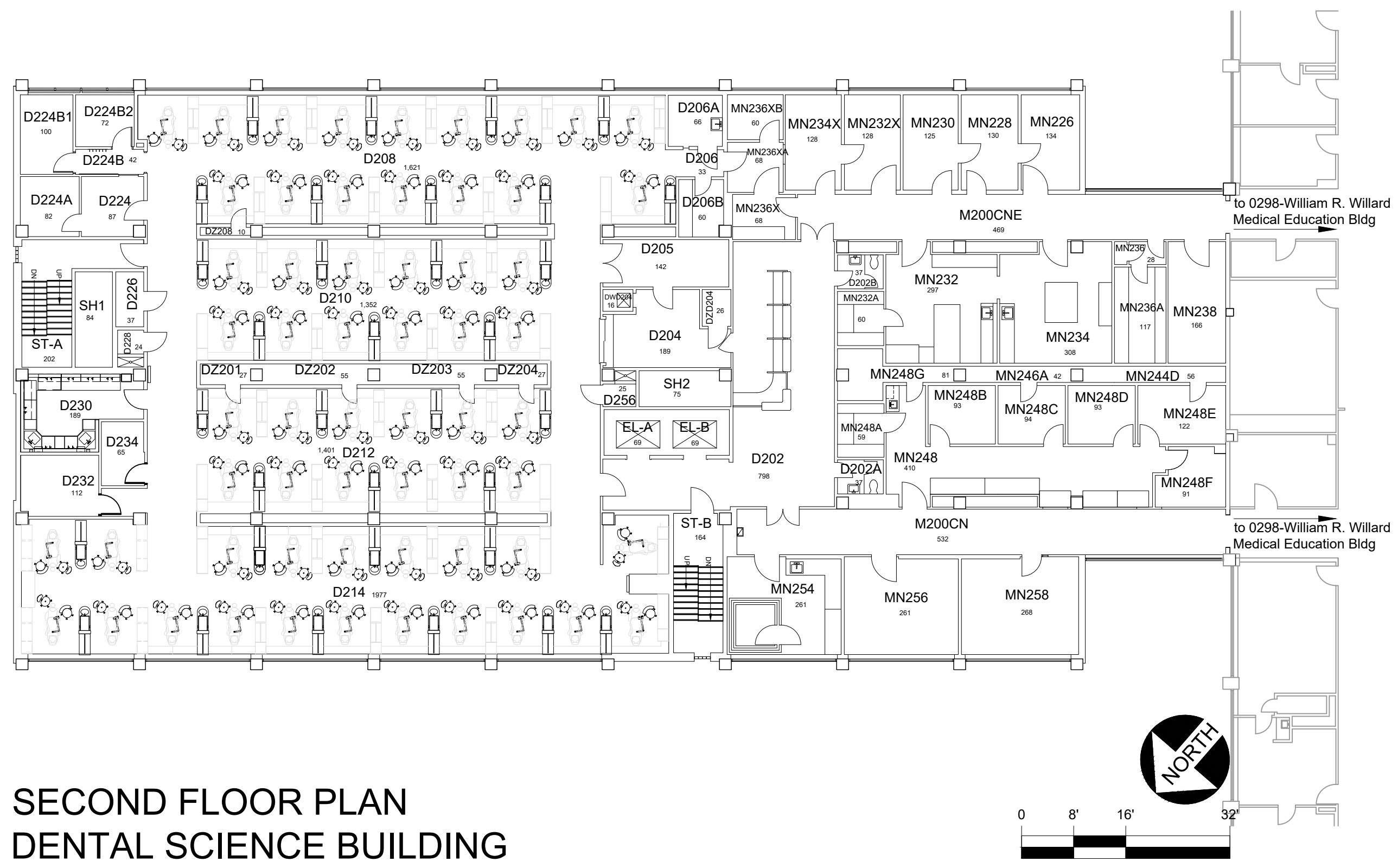

SECOND FLOOR PLAN
DENTAL SCIENCE BUILDING
15,814 Gross Square Ft.

6/4/2021

AKN

DATE:
09-23-12
DRAWN BY:
FR

BLDG #:
0297

DENTAL SCIENCE BLDG

KEY DRAWING

UNIVERSITY OF KENTUCKY
ITS Information Services

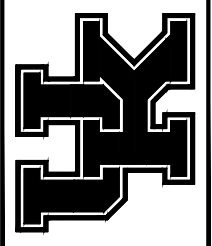

SHEET
4 of 9

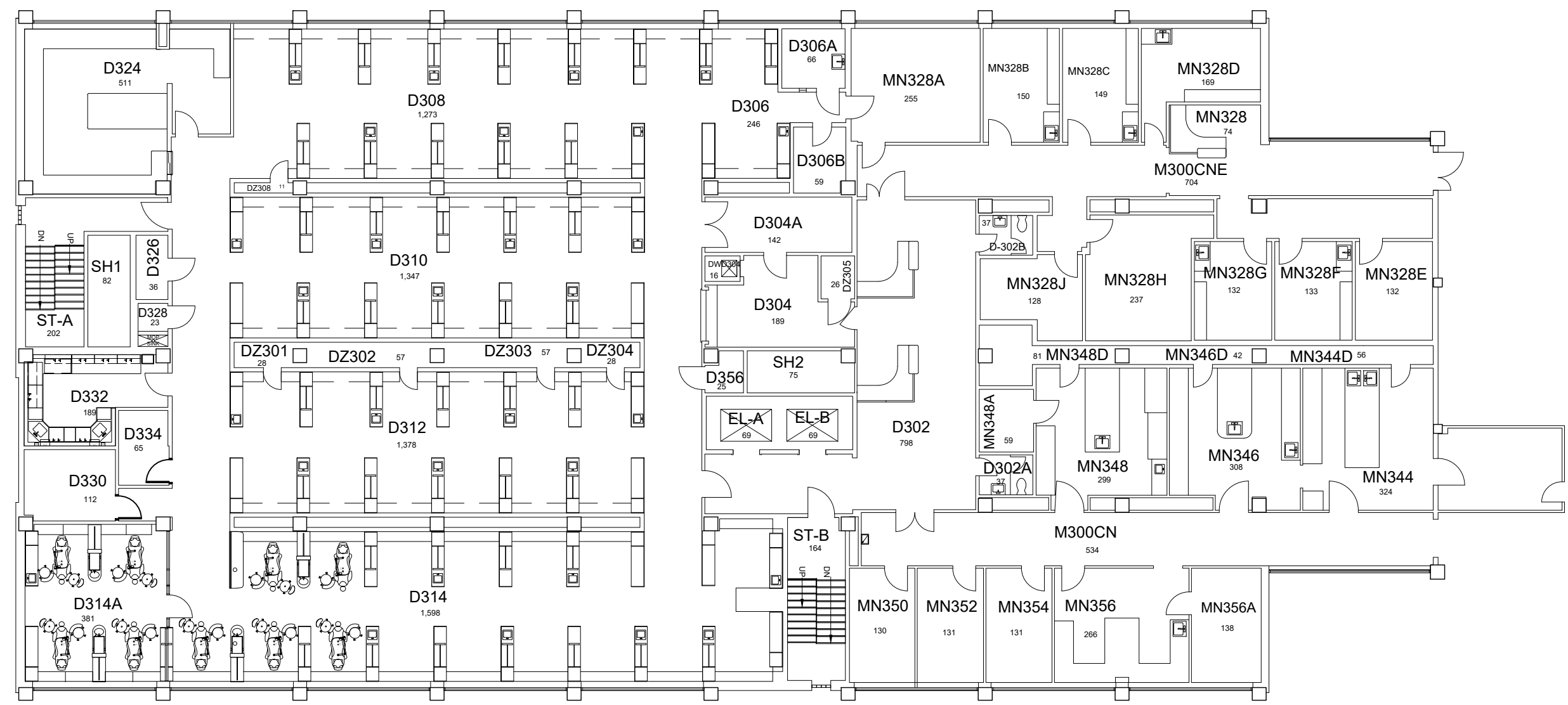

THIRD FLOOR PLAN
DENTAL SCIENCE BUILDING
15,815 Gross Square Ft.

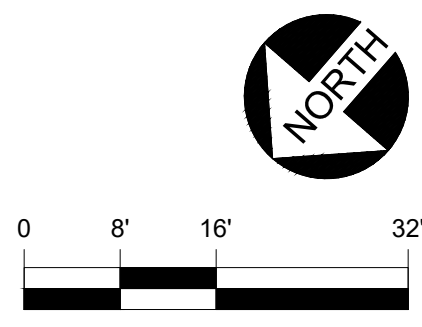

6/4/2021

AKN

DENTAL SCIENCE BLDG

KEY DRAWING

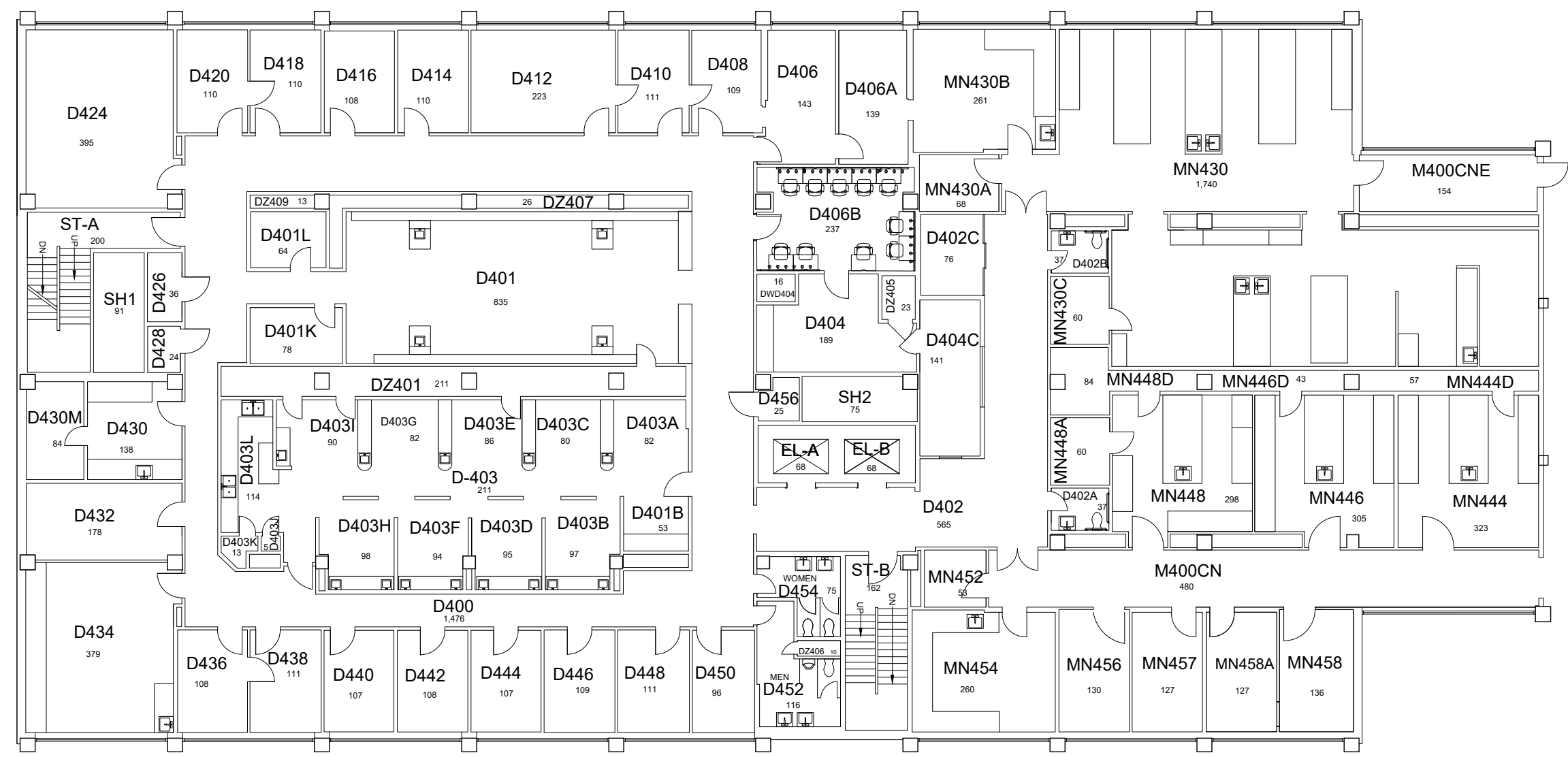

FOURTH FLOOR PLAN
DENTAL SCIENCE BUILDING
15,822 Gross Square Ft.

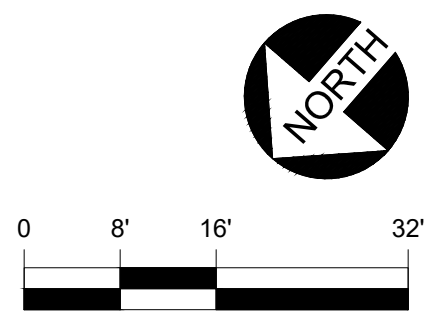

1/24/19

AKN

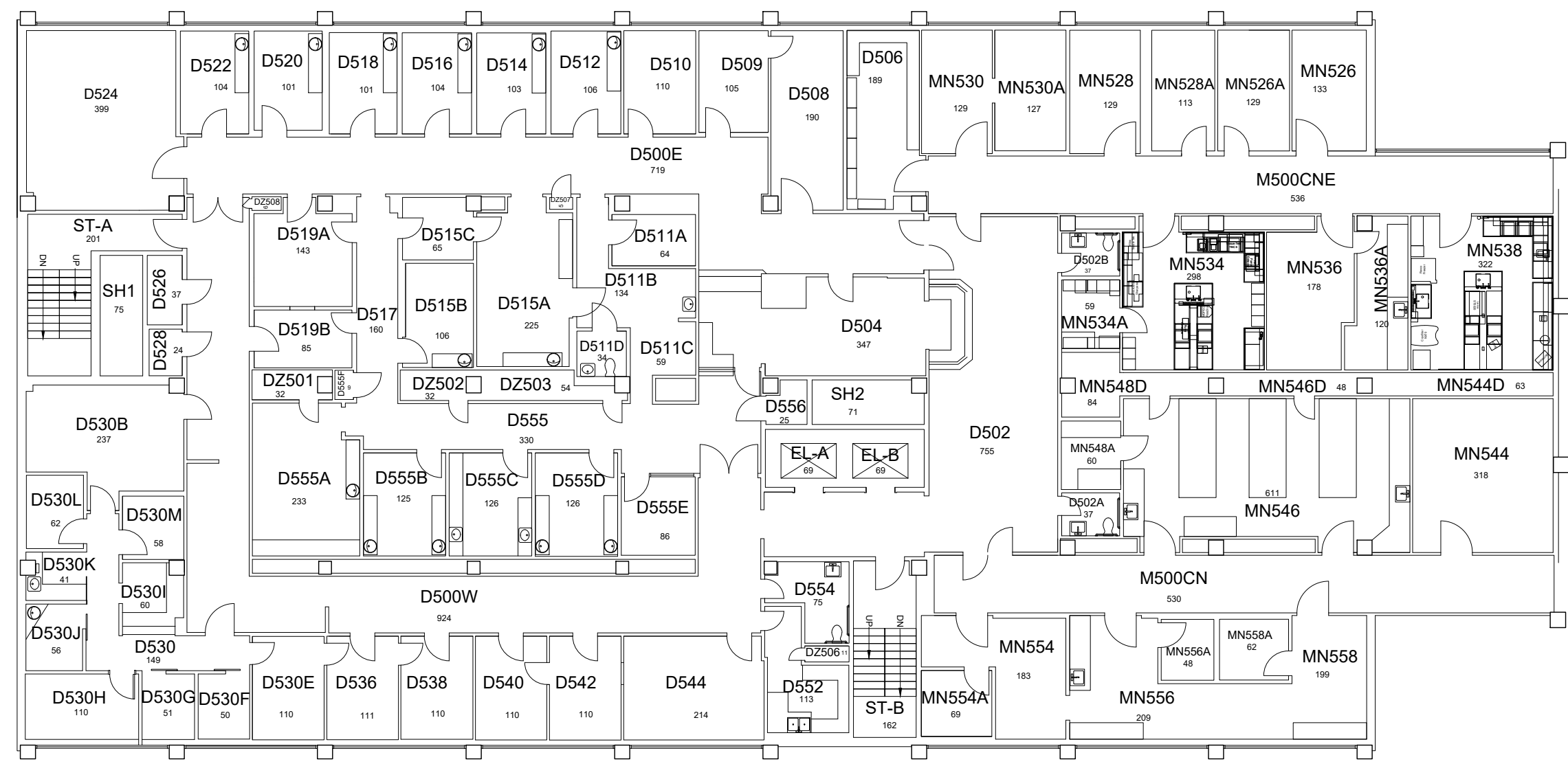
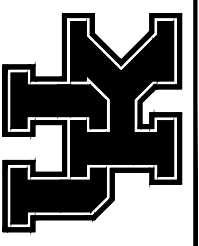

FIFTH FLOOR PLAN
DENTAL SCIENCE BUILDING
15,814 Gross Square Ft.

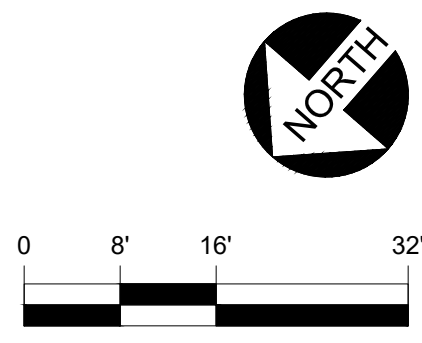

12/1/2022

NEK

DATE: 09-23-12
DRAWN BY: FR

BLDG #: 0297

DENTAL SCIENCE BLDG
KEY DRAWING

UNIVERSITY OF KENTUCKY
ITS Information Services

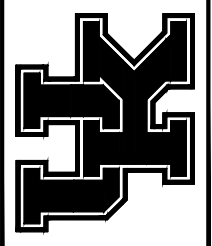

SHEET
7 of 9

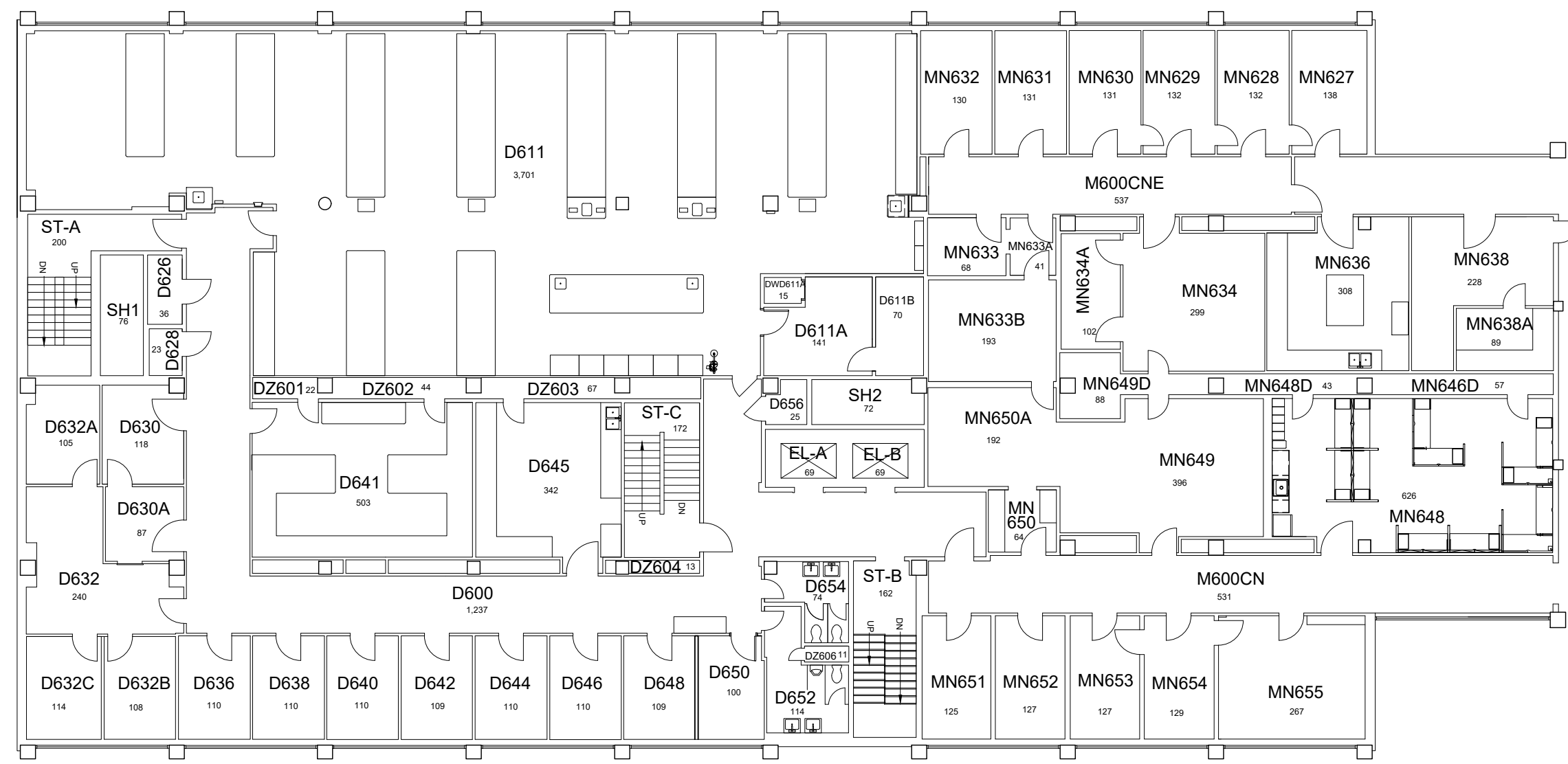

SIXTH FLOOR PLAN
DENTAL SCIENCE BUILDING
15,809 Gross Square Ft.

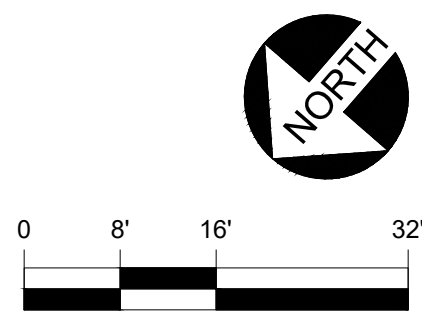

4/20/20

NEK

DATE:
09-23-12
DRAWN BY:
FR

BLDG #:
0297

DENTAL SCIENCE BLDG
KEY DRAWING

UNIVERSITY OF KENTUCKY
ITS Information Services

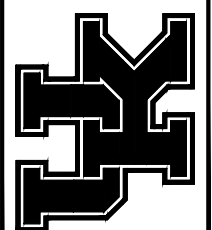

SHEET
8 of 9

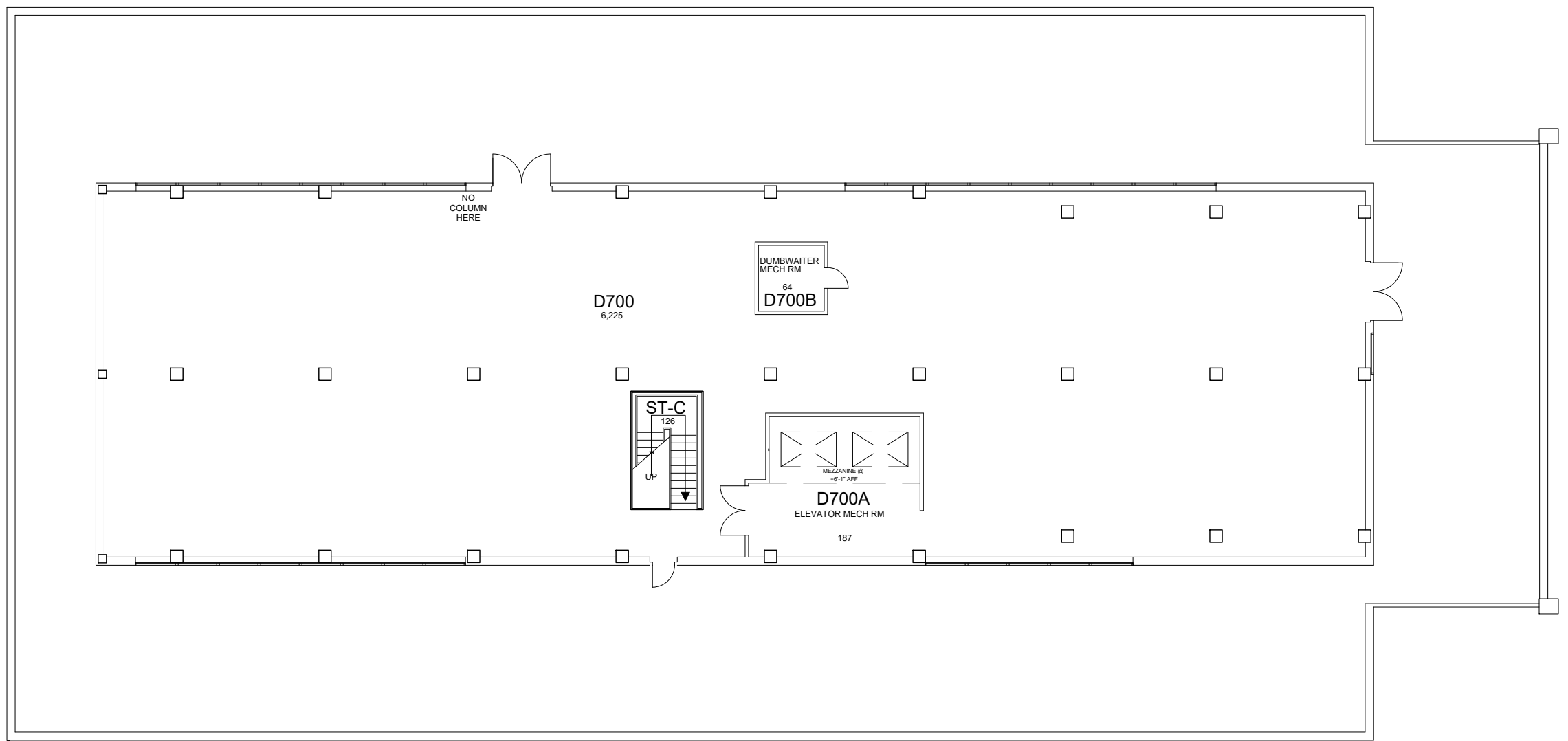

SEVENTH FLOOR PLAN
DENTAL SCIENCE BUILDING
7,179 Gross Square Ft.

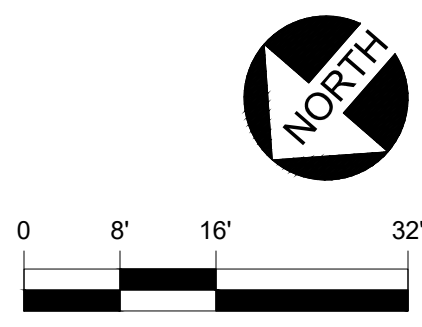

05-1-14

AJD

DATE:
09-23-12
DRAWN BY:
FR

BLDG #:
0297

DENTAL SCIENCE BLDG
KEY DRAWING

UNIVERSITY OF KENTUCKY
ITS Information Services

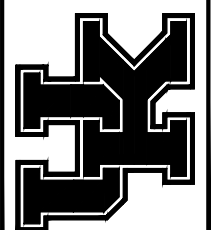

SHEET
9 of 9

LEGEND

- PLUMBING VENT
- ⊗ ROOF DRAIN
- ① SECTION NUMBER

ROOF DATA

Section	Roof Label	Location	Roof Type	Sq. Ft.
1	RF701	Outer Roof		7,525
2	RF802	Main Roof		7,200
3	RF703	South Roof		1,193
4	RF904	Mechanical Roof		86

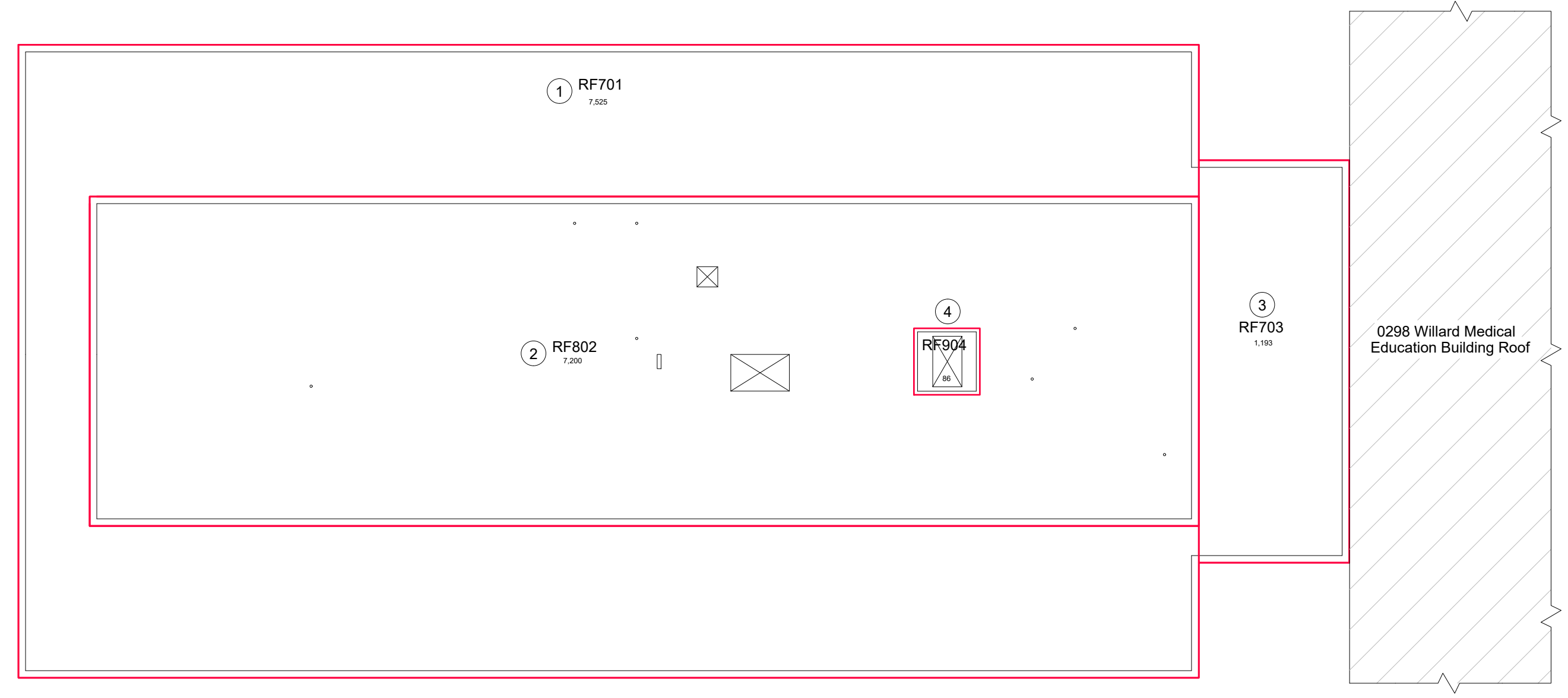

ROOF PLAN
DENTAL SCIENCE BUILDING

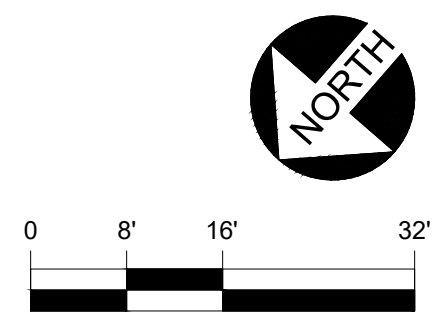

01-07-16

ALK