

FIRST FLOOR PLAN - CLASSROOM BUILDING
FIN. FL. ELEV. 982'-4"

- (C) - FIBERGLASS CIGARETTE URN
- (T) - FIBERGLASS TRASH CONTAINER

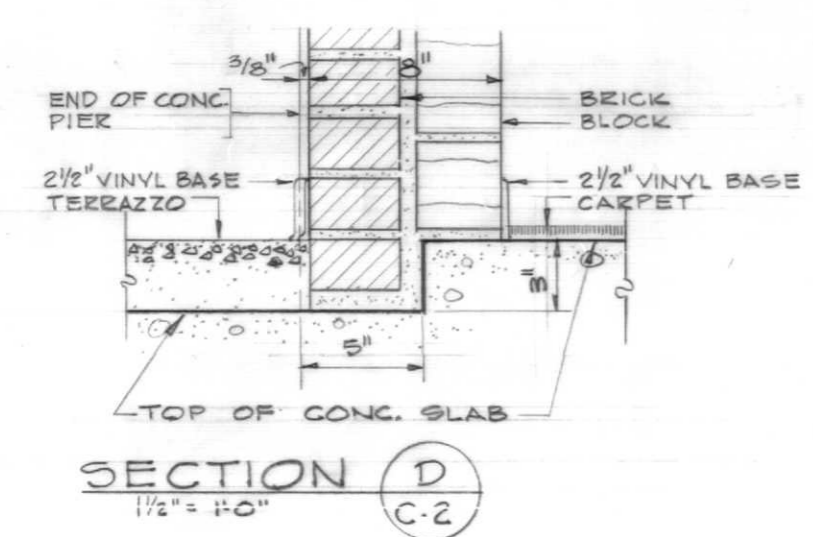

SECTION D
1 1/2" x 10"

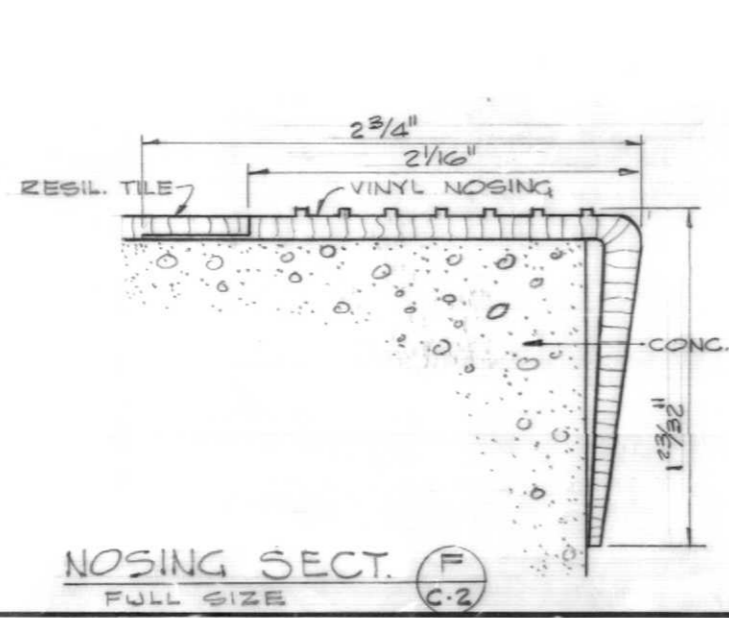

NOISING SECT. F
FULL SIZE

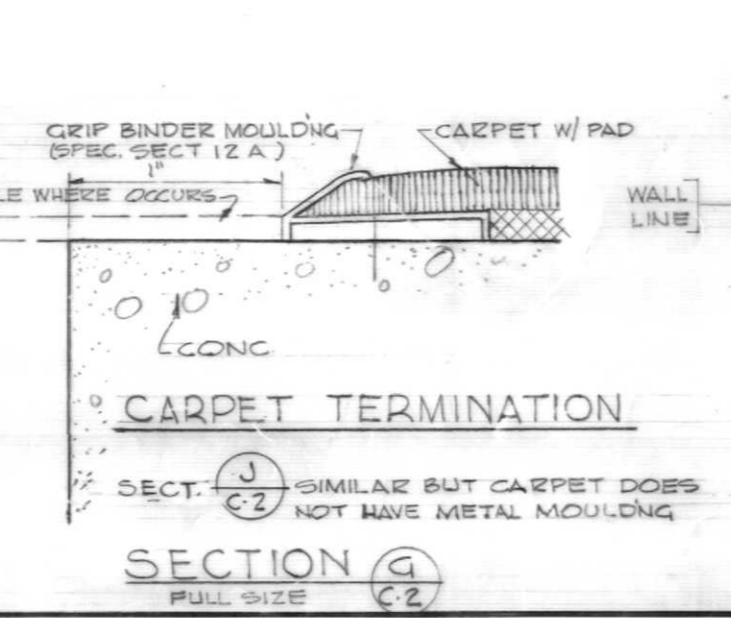

SECTION G
FULL SIZE

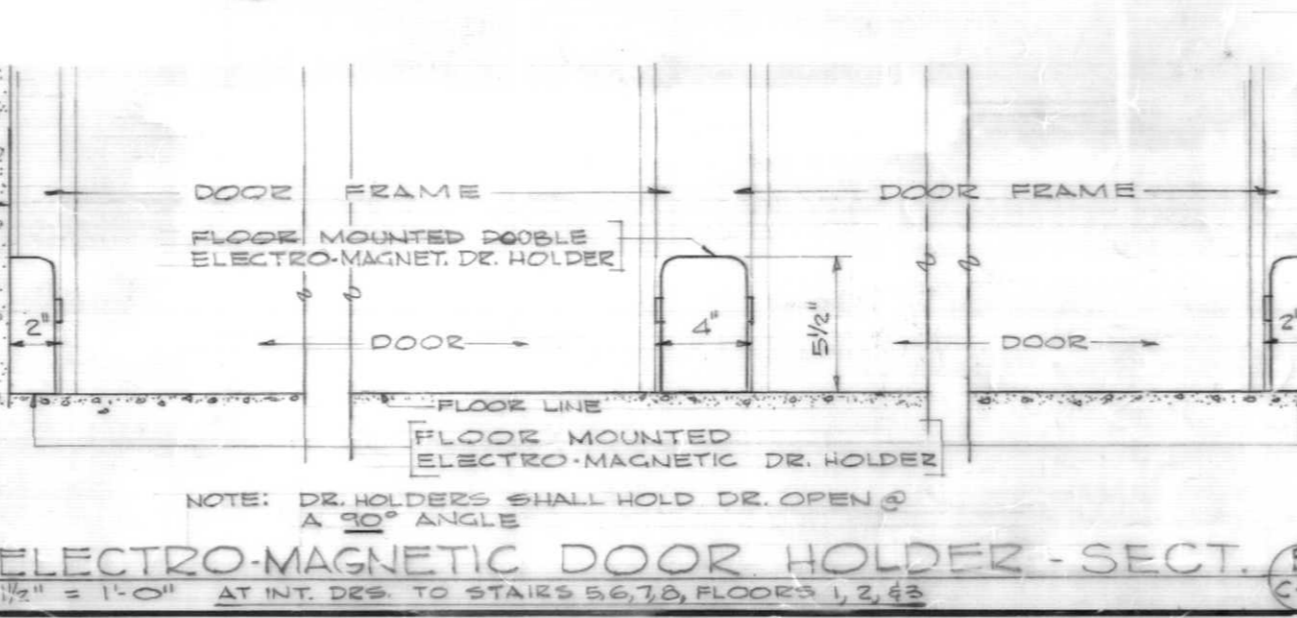

ELECTRO-MAGNETIC DOOR HOLDER - SECT. B
1 1/2" x 11" AT INT. DUE TO STAIRS 6.16, FLOOR 1, 2 & 3

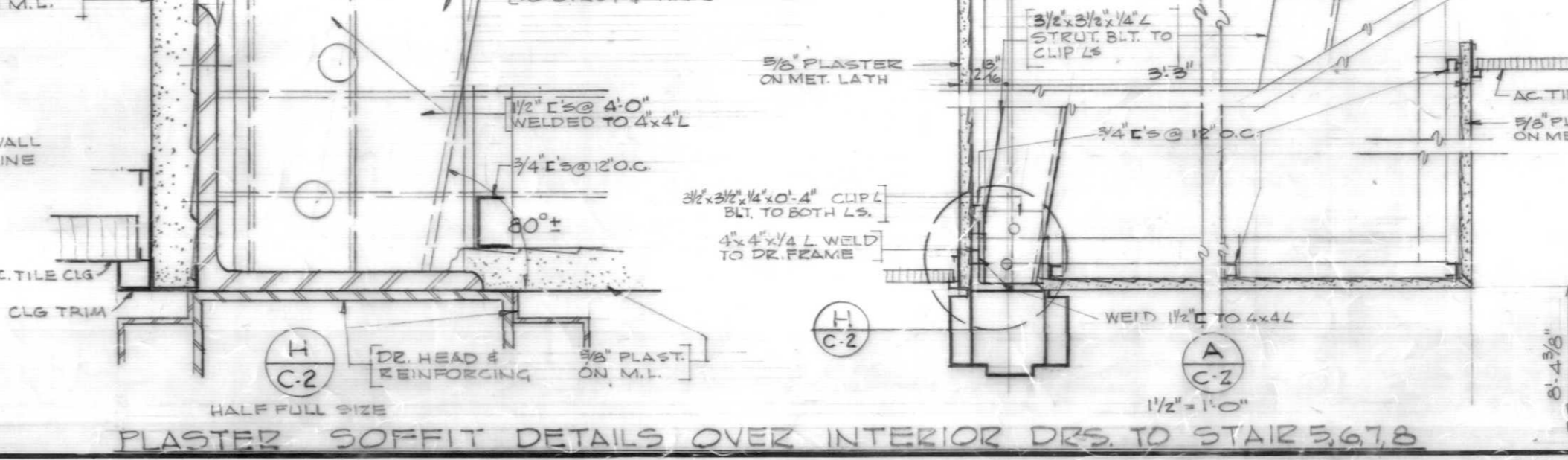

PLASTER SOFFIT DETAILS OVER INTERIOR DECS TO STAIRS 3, 6, 7, 8

FIRST FLOOR PLAN		
GENERAL CLASSROOM-OFFICE BUILDING		
UNIVERSITY OF KENTUCKY LEXINGTON, KENTUCKY		
SPEC. NO. 6503	JOHNSON - ROMANOWITZ ARCHITECTS	DRAWING NO. C-2
DRAWN BY J.R.C.	LEXINGTON, KENTUCKY	TOTAL SHEETS 157
CHECKED BY J.R.	COMMONWEALTH OF KENTUCKY DEPARTMENT OF FINANCE ENGINEERING STAFF	DATE DEC. 1966
REVISIONS	FRANKFORT, KENTUCKY	
APPROVED BY: [Signature]	AGENCY HEAD	DATE: 1/6/67
APPROVED BY: [Signature]	CHIEF OF STAFF	DATE: 1-10-67

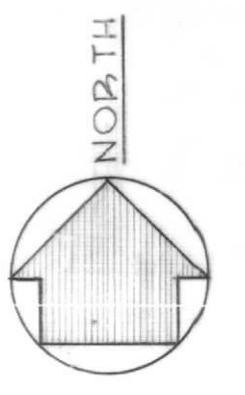

43/137

PROJECT NO. KY 2-1555
DATE: 1-10-67
4-3424