

Floor plan is from best available information.
Drawing will be updated as more information
becomes available.

DATE:
MARCH 2010
DRAWN BY:
DB

BLDG #:
0602

PATIENT CARE FACILITY (PAVILION A)
KEY DRAWING

UNIVERSITY OF KENTUCKY
ITS Information Services

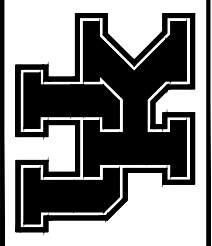

SHEET
1 of 22

9/1/20

AKN

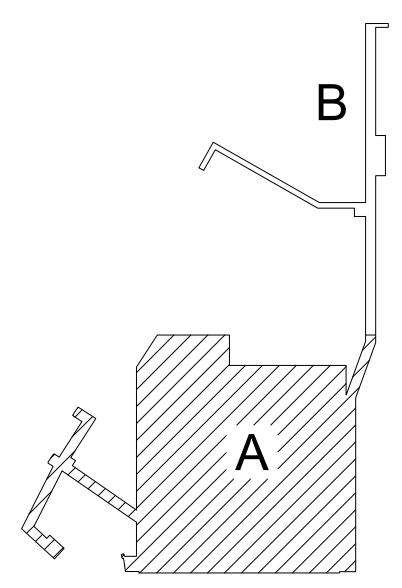
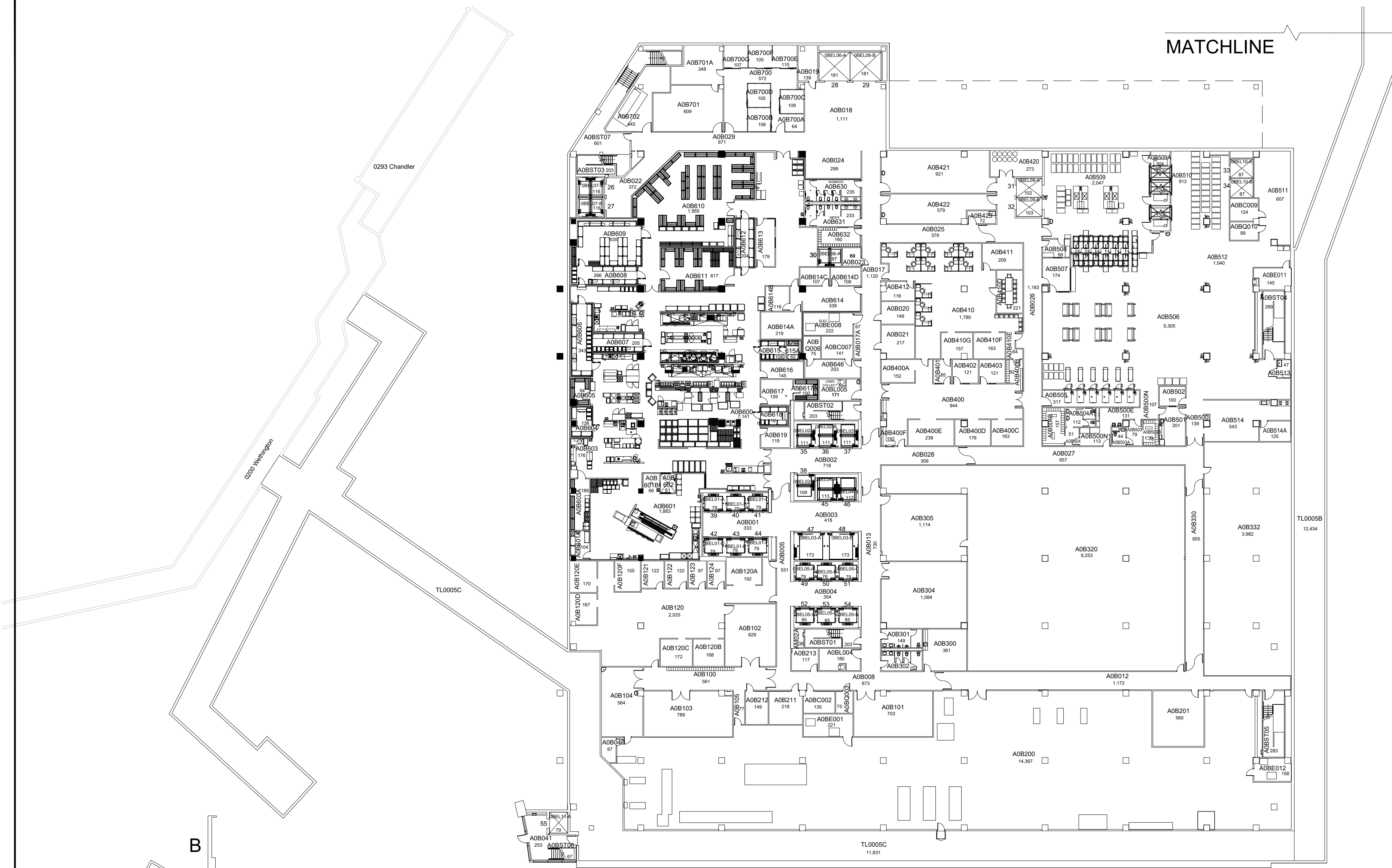

KEY PLAN - BASEMENT
N.T.S

BASEMENT FLOOR PLAN - A PATIENT CARE FACILITY (PAVILION A)

133,593 Gross Square Ft.

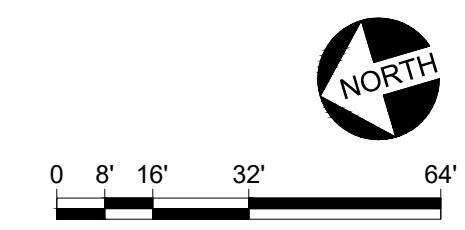

Floor plan is from best available information.
Drawing will be updated as more information
becomes available.

DATE:
MARCH 2010
DRAWN BY:
DB

BLDG #:
0602

PATIENT CARE FACILITY (PAVILION A)
KEY DRAWING

UNIVERSITY OF KENTUCKY
ITS Information Services

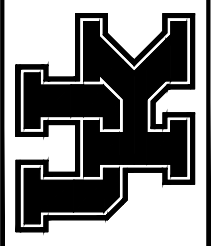

SHEET
2 of 22

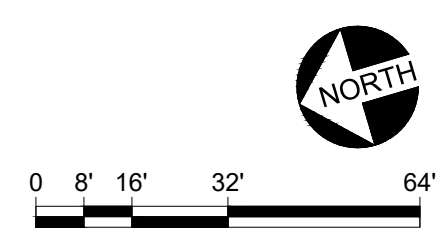
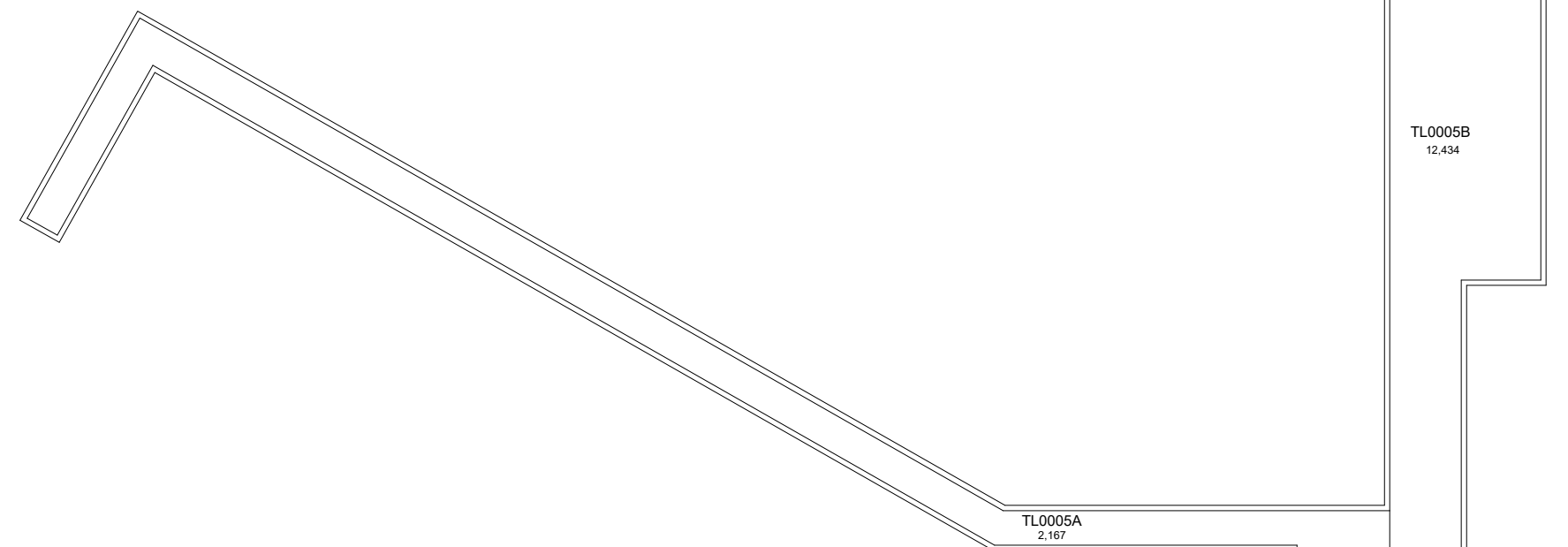

MATCHLINE

BASEMENT FLOOR PLAN - B PATIENT CARE FACILITY (PAVILION A)

133,593 Gross Square Ft.

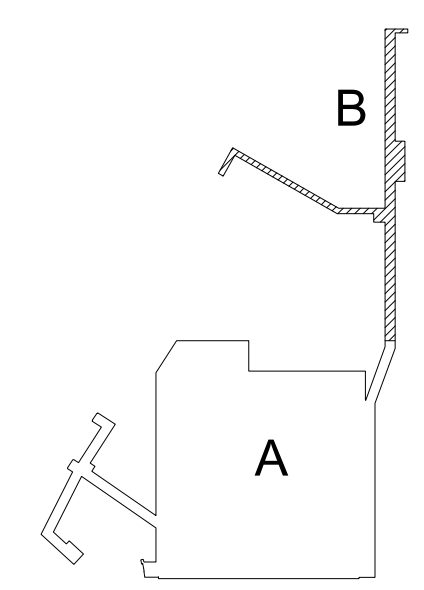
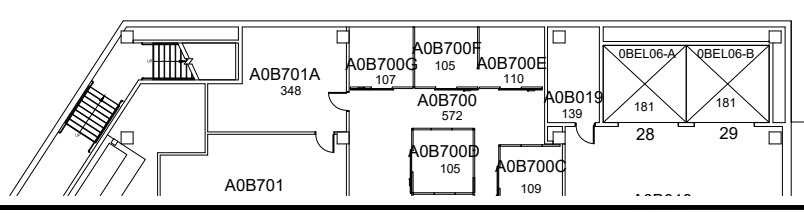

KEY PLAN - BASEMENT
N.T.S

5-16-16

JES

Floor plan is from best available information.
Drawing will be updated as more information
becomes available.

DATE:
MARCH 2010
DRAWN BY:
DB

BLDG #:
0602

PATIENT CARE FACILITY (PAVILION A)
KEY DRAWING

UNIVERSITY OF KENTUCKY
ITS Information Services

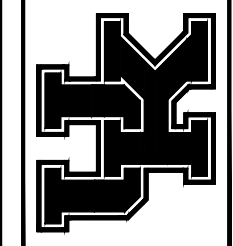

SHEET
3 of 22

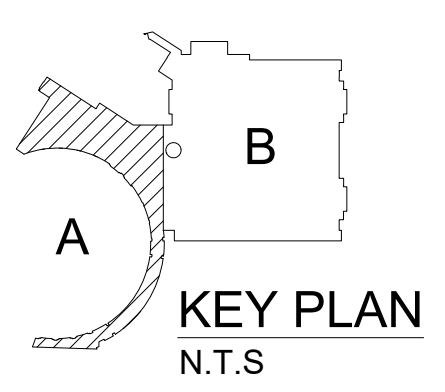
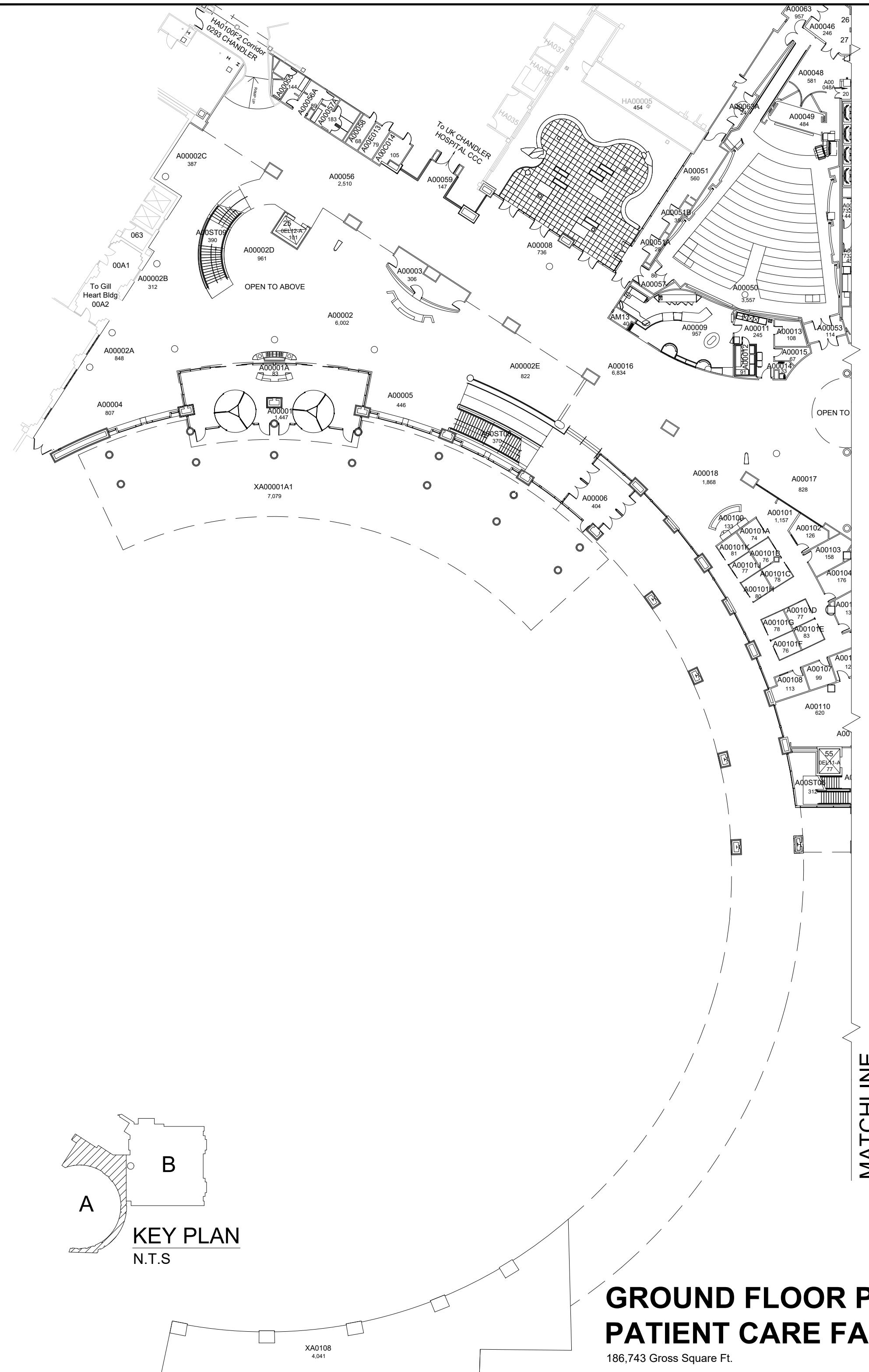

GROUND FLOOR PLAN - A
PATIENT CARE FACILITY (PAVILION A)
186,743 Gross Square Ft.

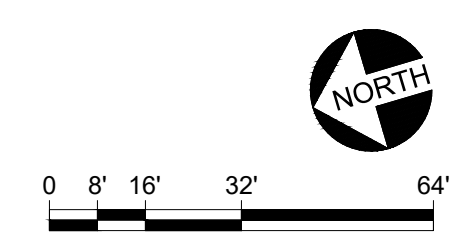

10/11/2021
JES

Floor plan is from best available information. Drawing will be updated as more information becomes available.

PROJECT AREA ON HOLD
Radiology Phase 2 (2402.12)

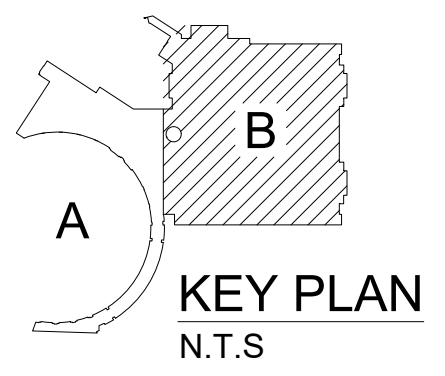

GROUND FLOOR PLAN - B PATIENT CARE FACILITY (PAVILION A)

186,743 Gross Square Ft.

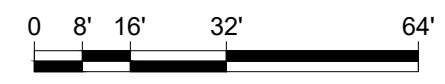

DATE:
MARCH 2010
DRAWN BY:
DB

BLDG #:
0602

PATIENT CARE FACILITY (PAVILION A)
KEY DRAWING

UNIVERSITY OF KENTUCKY
ITS Information Services

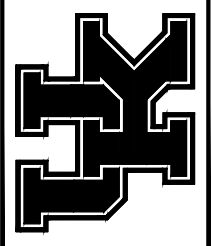

SHEET
4 of 22

10/11/2021

JES

Floor plan is from best available information.
Drawing will be updated as more information
becomes available.

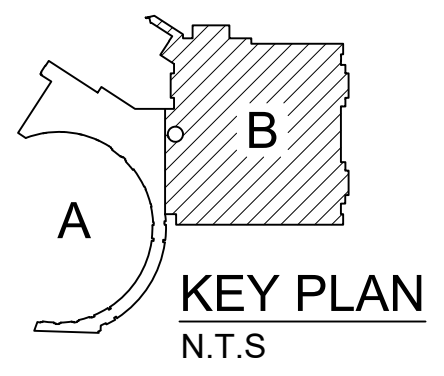
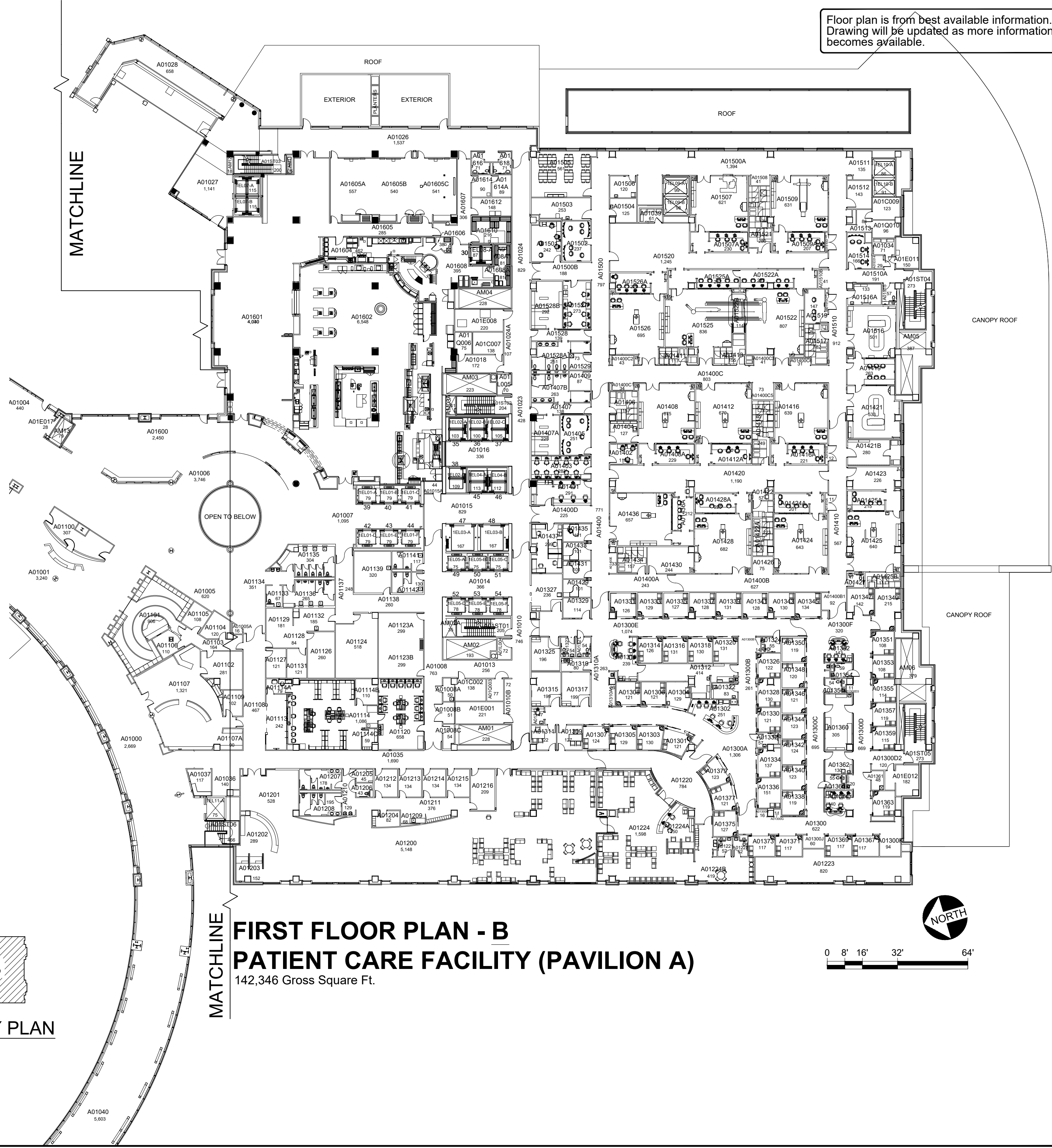

FIRST FLOOR PLAN - B
PATIENT CARE FACILITY (PAVILION A)
142,346 Gross Square Ft.

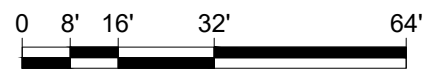

DATE:
MARCH 2010
DRAWN BY:
DB

BLDG #:
PATIENT CARE FACILITY (PAVILION A)
0602
KEY DRAWING

UNIVERSITY OF KENTUCKY
ITS Information Services

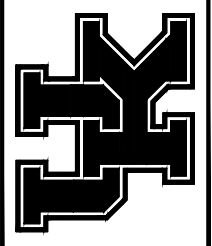

SHEET
6 of 22

2/1/21

AKN

DATE:
MARCH 2010
DRAWN BY:
DB

BLDG #:
PATIENT CARE FACILITY (PAVILION A)
0602
KEY DRAWING

UNIVERSITY OF KENTUCKY
ITS Information Services

SHEET
7 of 22

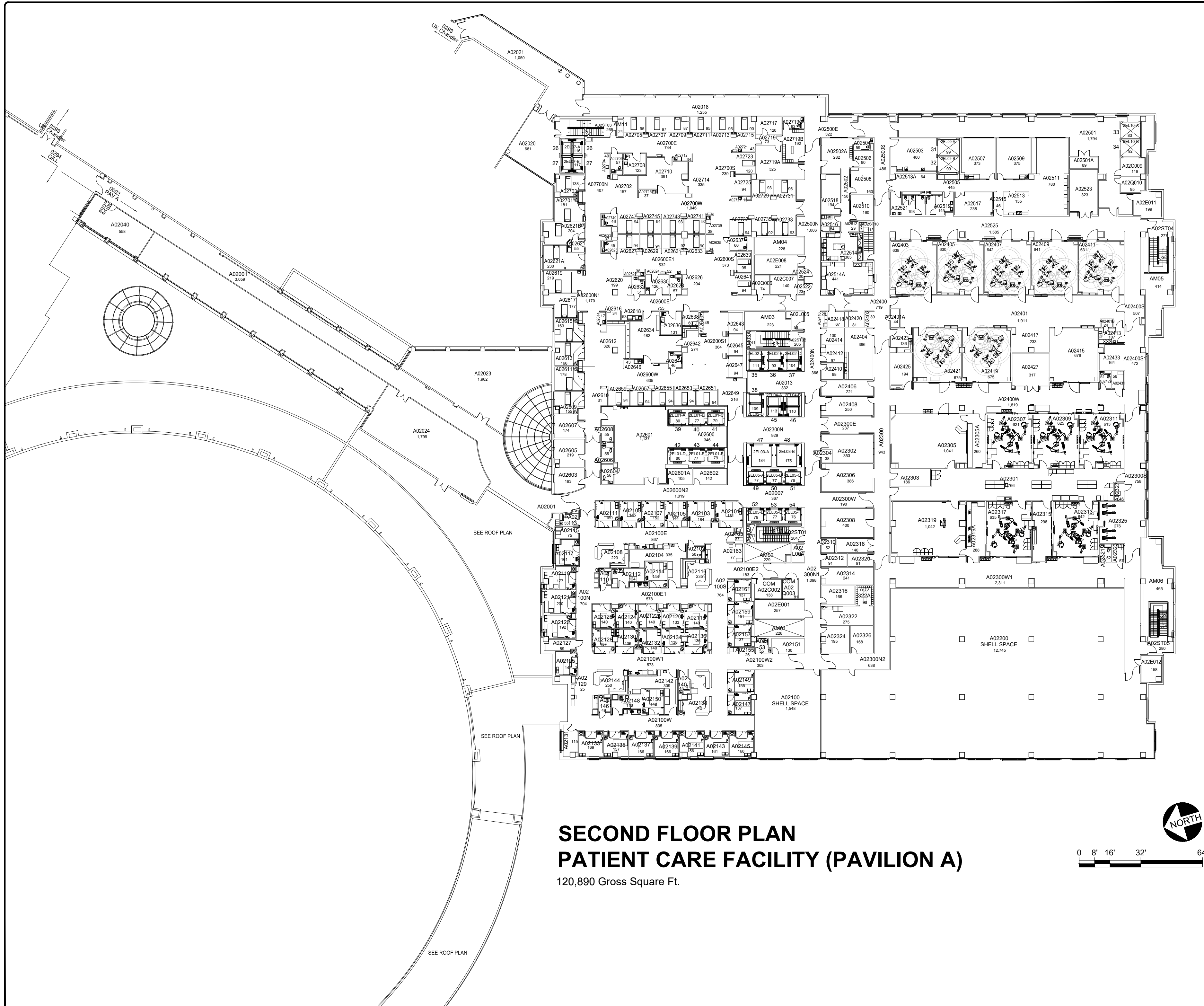

SECOND FLOOR PLAN PATIENT CARE FACILITY (PAVILION A)

120,890 Gross Square Ft.



0 8' 16' 32' 64'

6/22/21

KMD

Floor plan is from best available information.
Drawing will be updated as more information
becomes available.

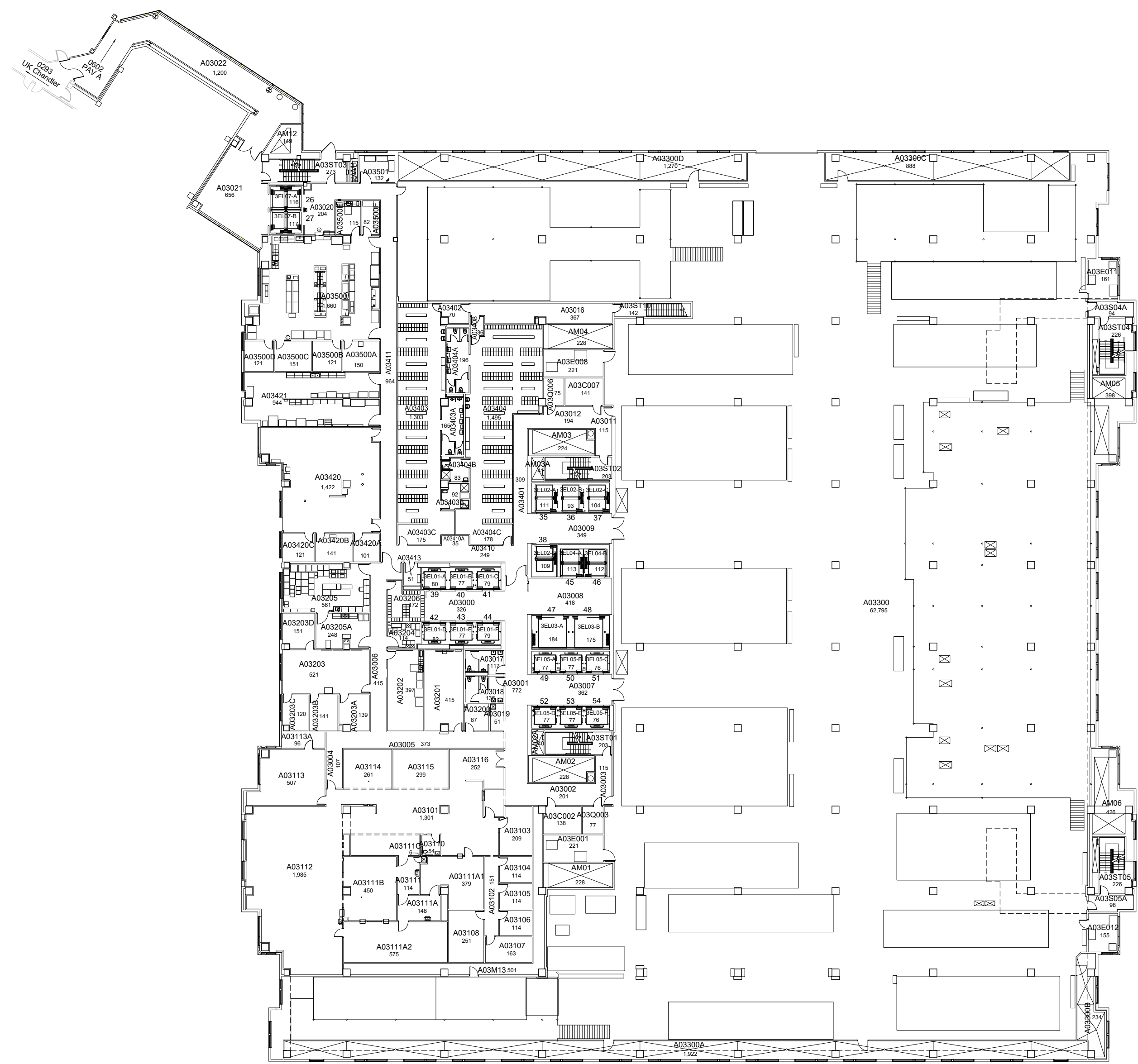

THIRD FLOOR PLAN PATIENT CARE FACILITY (PAVILION A)

107,346 Gross Square Ft.

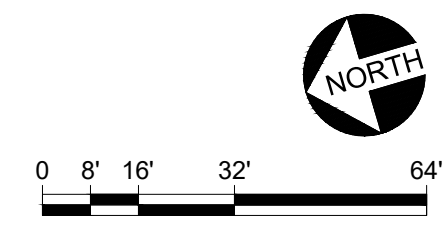

DATE:
MARCH 2010
DRAWN BY:
DB

BLDG #:
0602

PATIENT CARE FACILITY (PAVILION A) KEY DRAWING

UNIVERSITY OF KENTUCKY
ITS Information Services

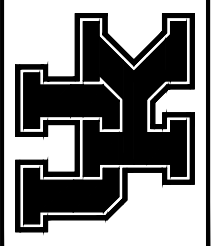

SHEET
8 of 22

12/5/2017

AKN

3/25/19

NEK

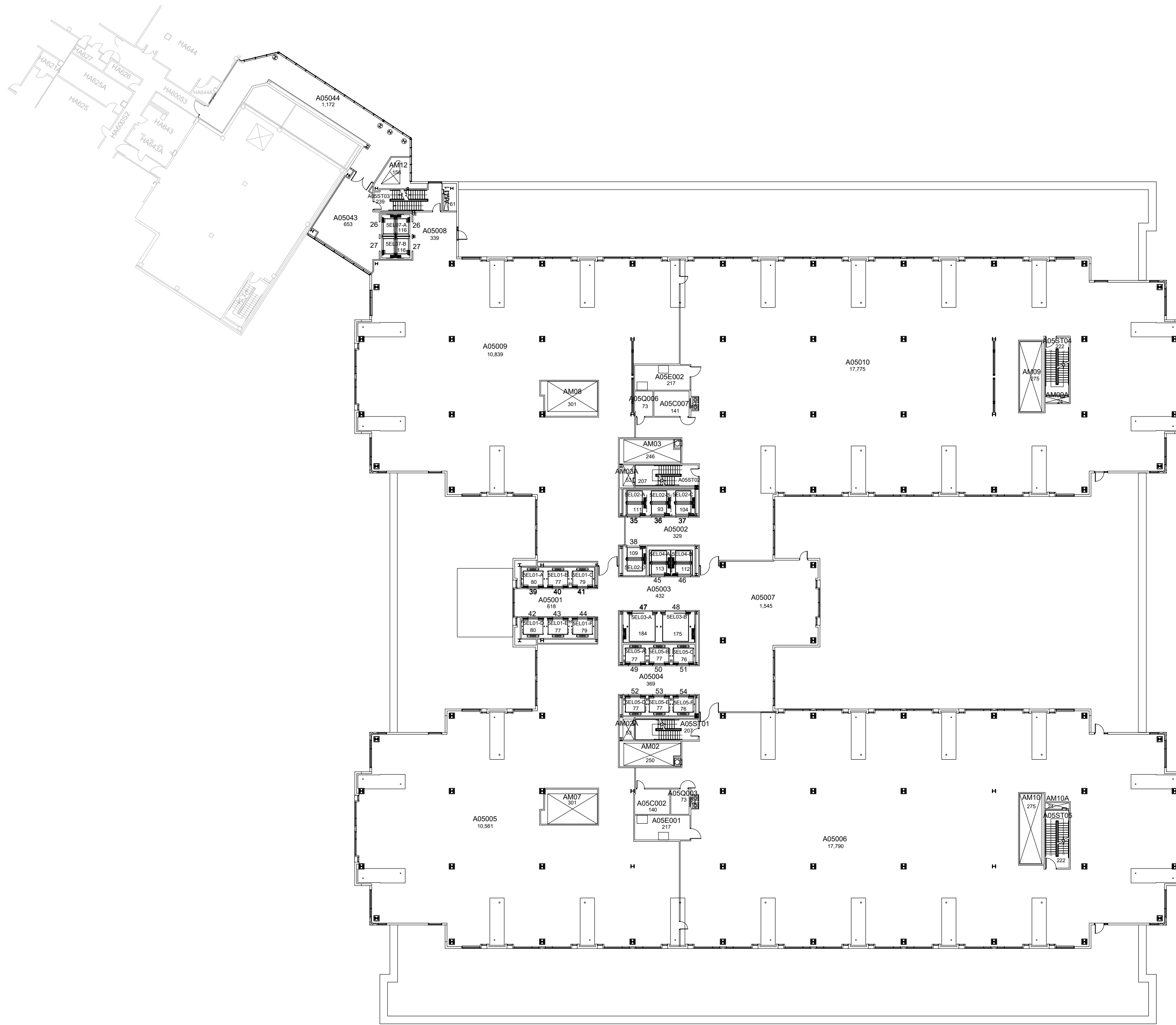

**FIFTH FLOOR PLAN
PATIENT CARE FACILITY (PAVILION A)**

71,727 Gross Square Ft.

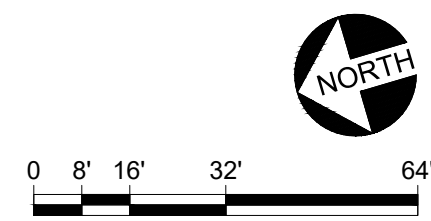

DATE:
MARCH 2010
DRAWN BY:
DB

BLDG #:
0602

PATIENT CARE FACILITY (PAVILION A)

KEY DRAWING

UNIVERSITY OF KENTUCKY
ITS Information Services

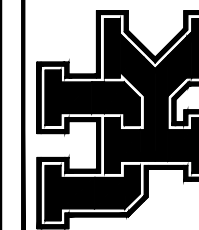

SHEET
10 of 22

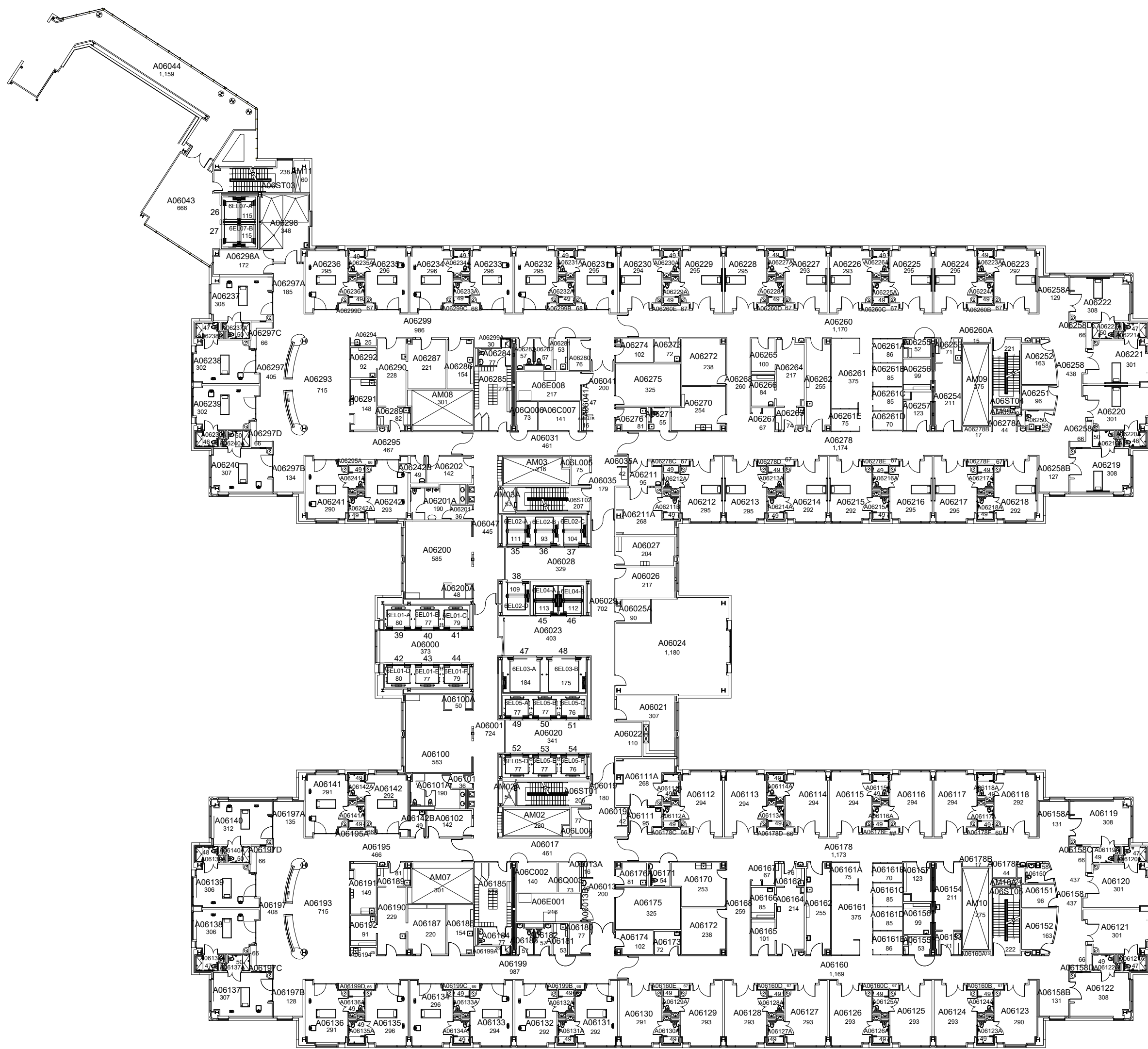

**SIXTH FLOOR PLAN
PATIENT CARE FACILITY (PAVILION A)**

71,807 Gross Square Ft.

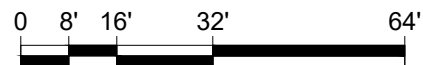

DATE:
MARCH 2010
DRAWN BY:
DB

BLDG #:
0602

PATIENT CARE FACILITY (PAVILION A)
KEY DRAWING

UNIVERSITY OF KENTUCKY
ITS Information Services

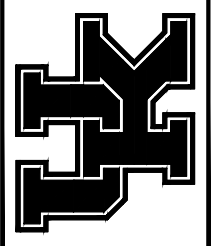

SHEET
11 of 22

5-12-16

SB

PATIENT CARE FACILITY (PAVILION A)

KEY DRAWING

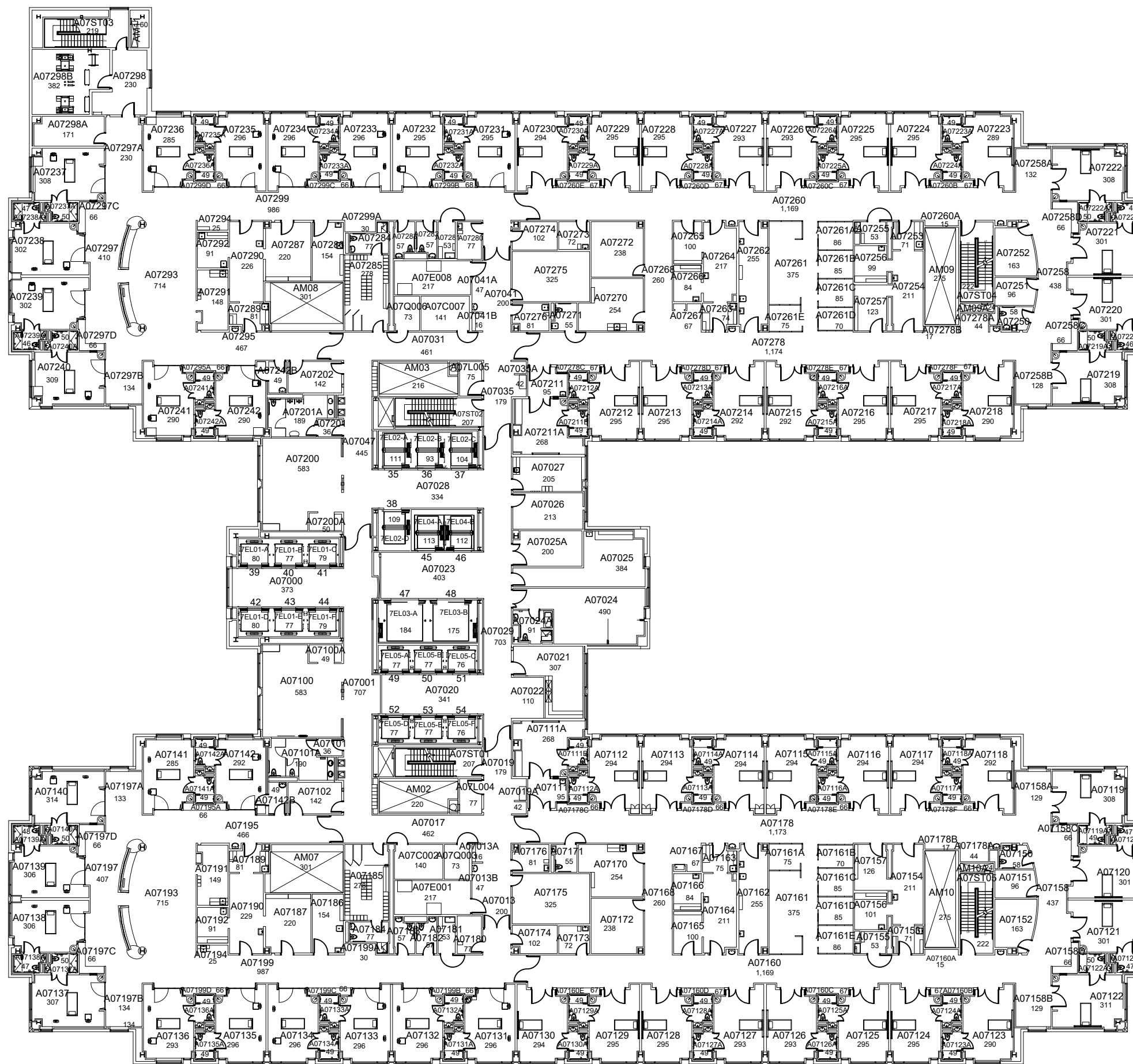
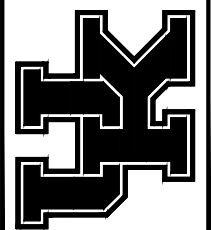

SEVENTH FLOOR PLAN
PATIENT CARE FACILITY (PAVILION A)

69,757 Gross Square Ft.

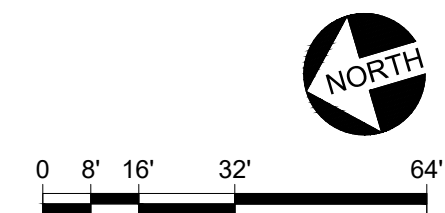

5-12-16

SB

Floor plan is from best available information.
Drawing will be updated as more information
becomes available.

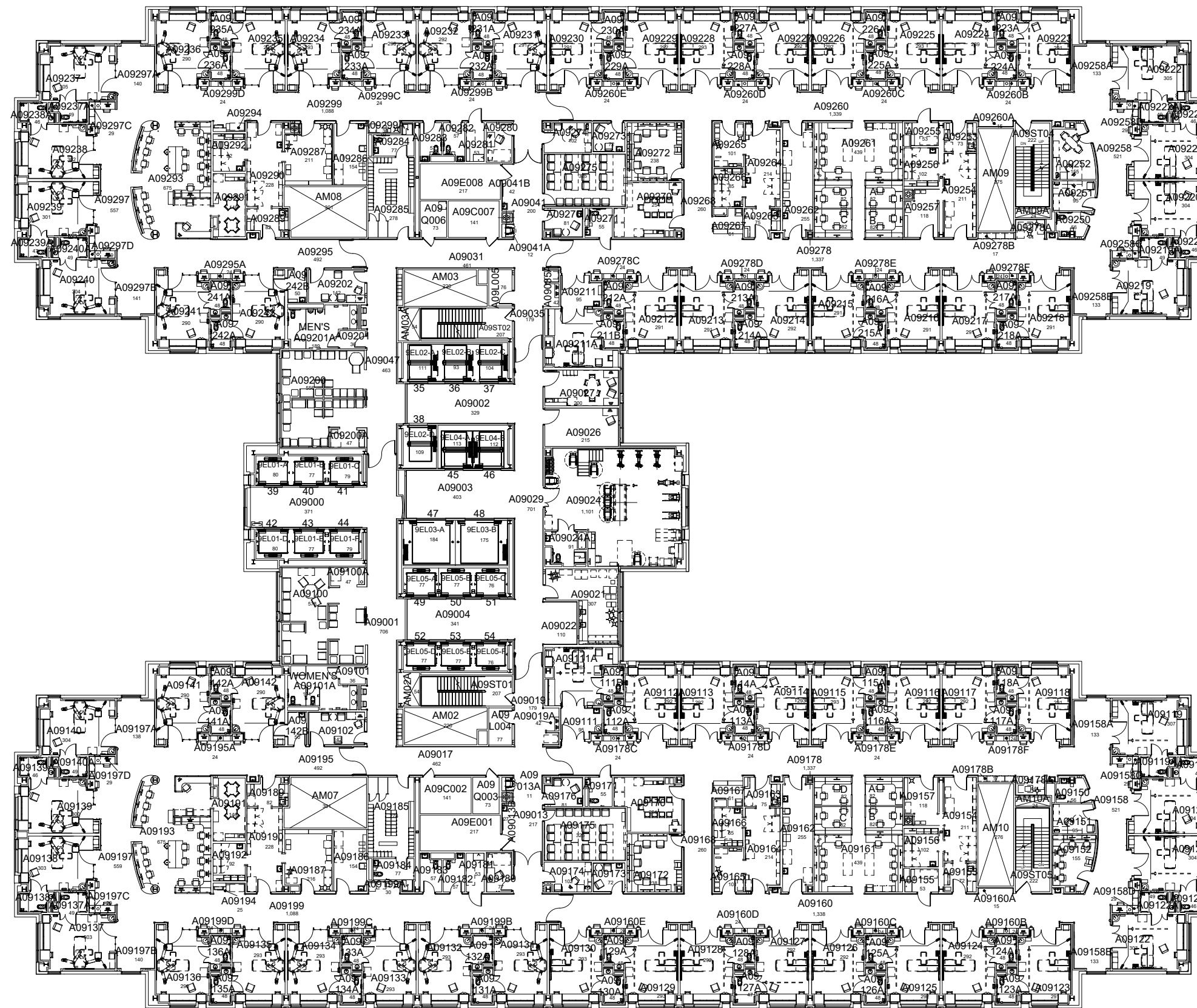

NINTH FLOOR PLAN PATIENT CARE FACILITY (PAVILION A)

68,170 Gross Square Ft.

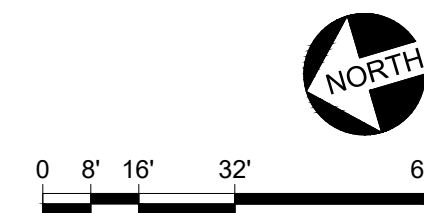

DATE:
MARCH 2010
DRAWN BY:
DB

BLDG #:
0602

PATIENT CARE FACILITY (PAVILION A) KEY DRAWING

UNIVERSITY OF KENTUCKY
ITS Information Services

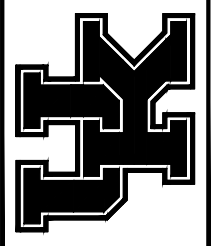

SHEET
14 of 22

12/12/19

SHW

Floor plan is from best available information.
Drawing will be updated as more information
becomes available.

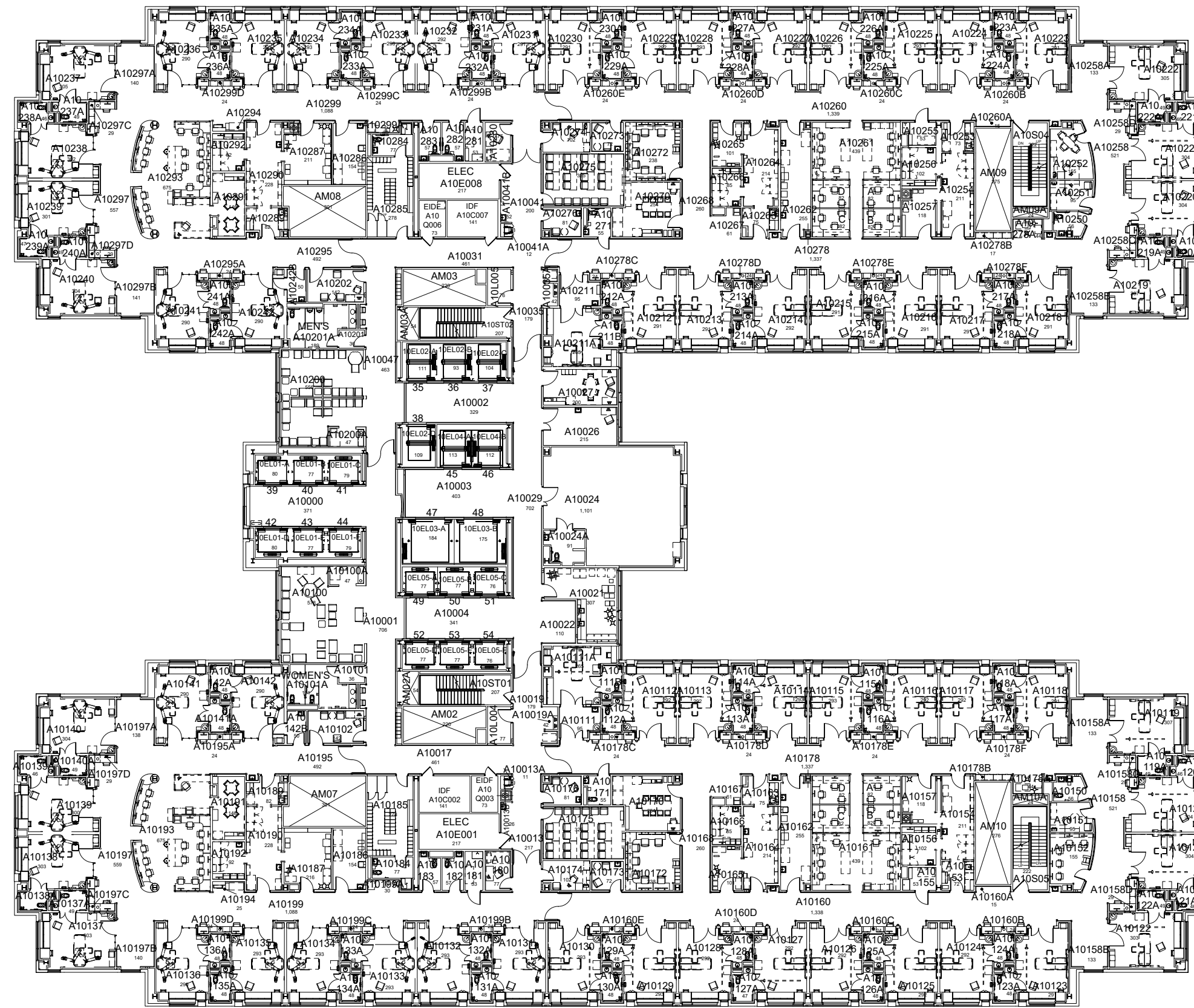

TENTH FLOOR PLAN PATIENT CARE FACILITY (PAVILION A)

68,170 Gross Square Ft.



0 8' 16' 32' 64'

DATE:
MARCH 2010
DRAWN BY:
DB

BLDG #:
0602

PATIENT CARE FACILITY (PAVILION A)

KEY DRAWING

UNIVERSITY OF KENTUCKY
ITS Information Services

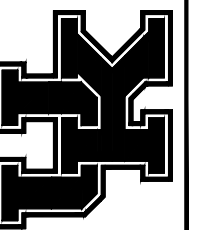

SHEET
15 of 22

DATE:
MARCH 2010
DRAWN BY:
DB

BLDG #:
0602

PATIENT CARE FACILITY (PAVILION A)

KEY DRAWING

UNIVERSITY OF KENTUCKY
ITS Information Services

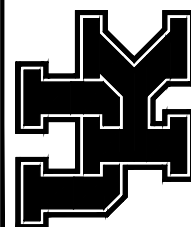

SHEET
17 of 22

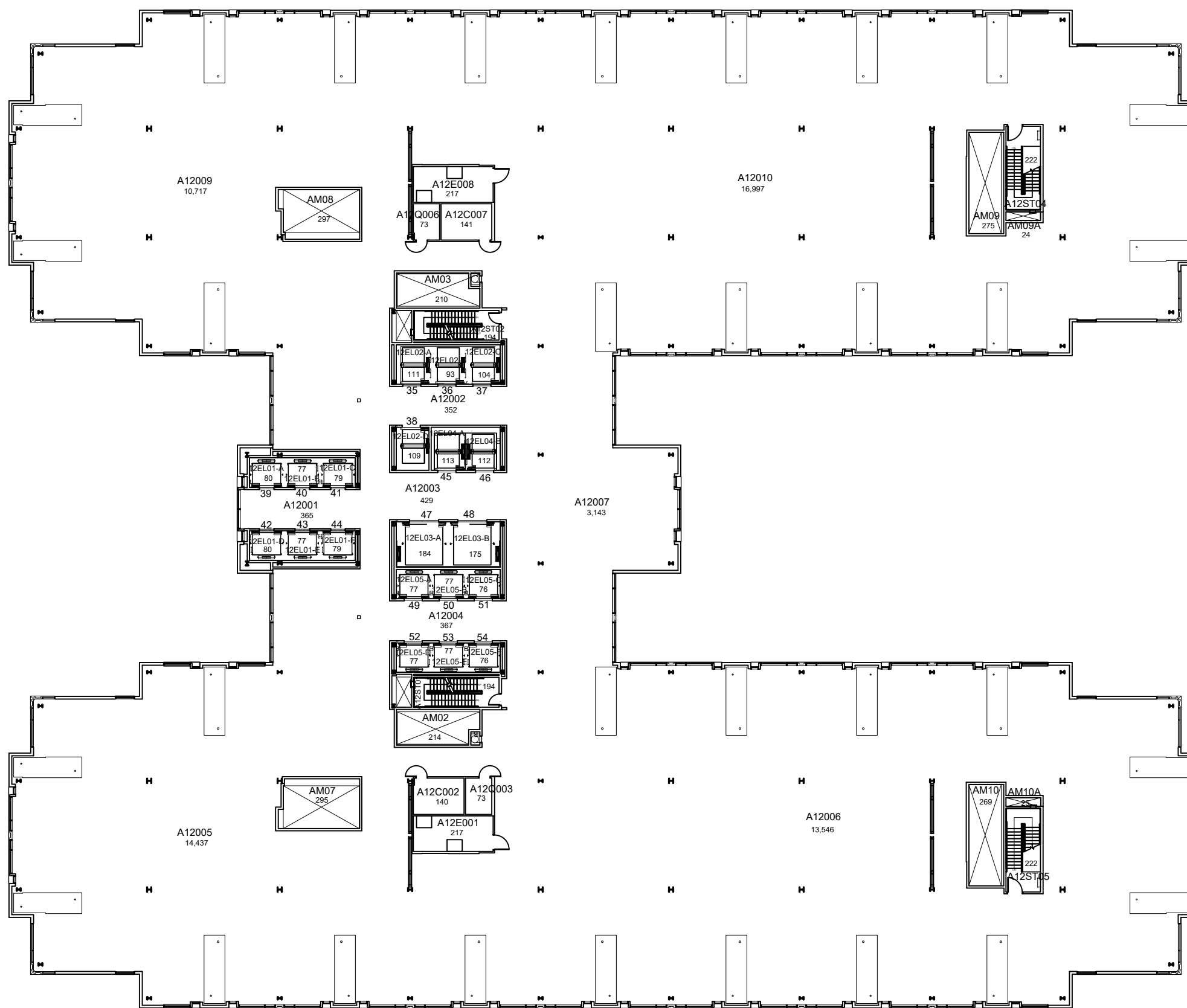

**TWELFTH FLOOR PLAN
PATIENT CARE FACILITY (PAVILION A)**

68,417 Gross Square Ft.

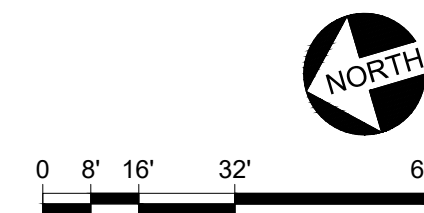

5-12-16

SB

DATE:
MARCH 2010
DRAWN BY:
DB

BLDG #:
0602

PATIENT CARE FACILITY (PAVILION A)

KEY DRAWING

UNIVERSITY OF KENTUCKY
ITS Information Services

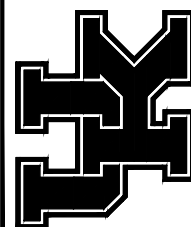

SHEET
18 of 22

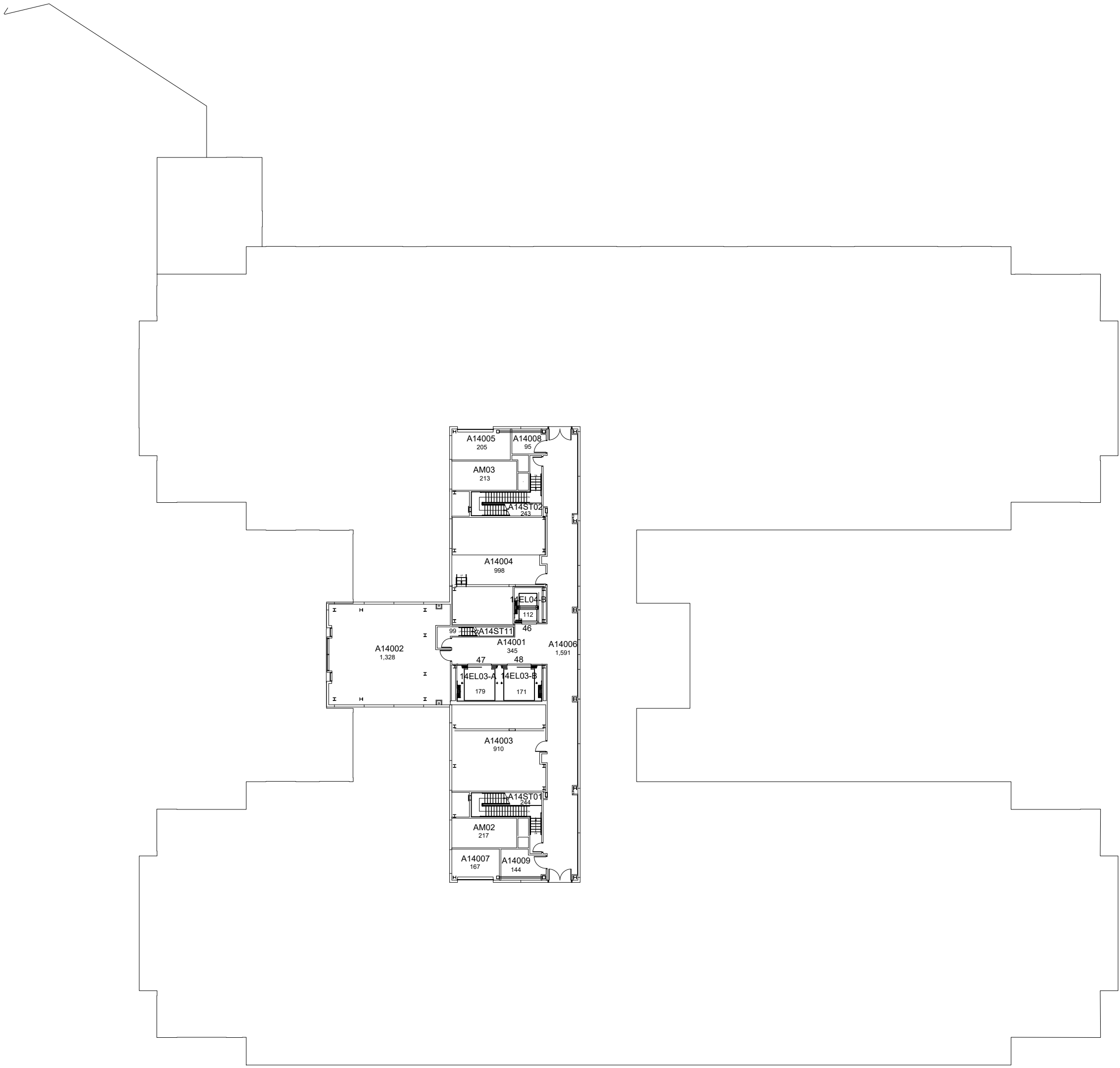

**FOURTEENTH FLOOR PLAN
PATIENT CARE FACILITY (PAVILION A)**

8,197 Gross Square Ft.

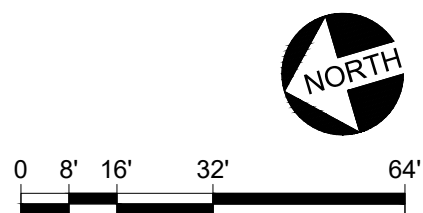

5-12-16

SB

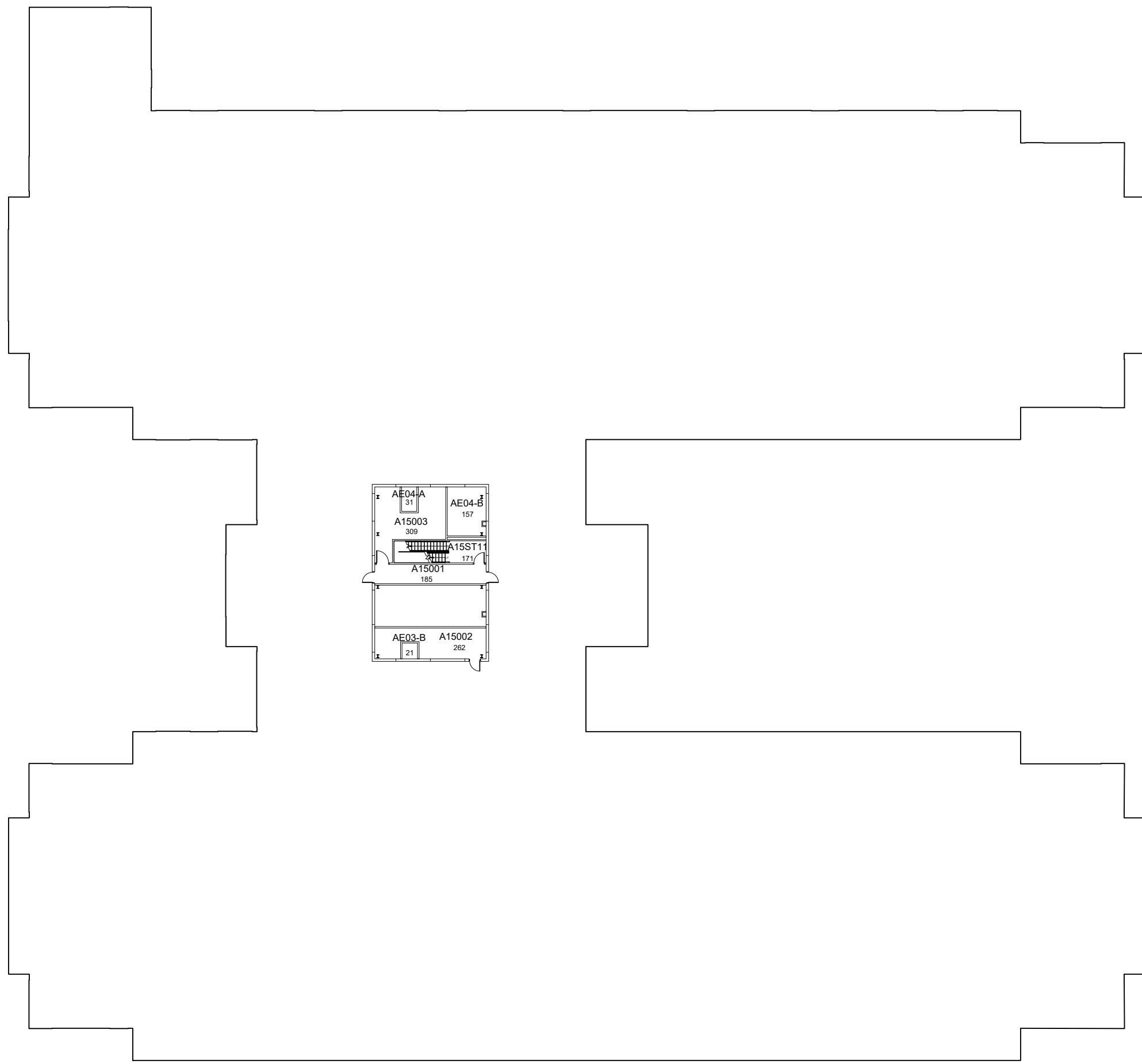

**FIFTEENTH FLOOR PLAN
PATIENT CARE FACILITY (PAVILION A)**

1,729 Gross Square Ft.

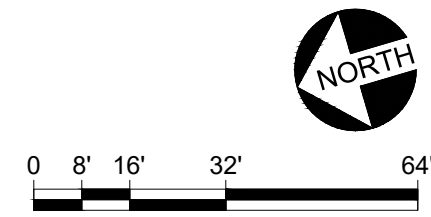

DATE:
MARCH 2010
DRAWN BY:
DB

PATIENT CARE FACILITY (PAVILION A)
BLDG #:
0602
KEY DRAWING

UNIVERSITY OF KENTUCKY
ITS Information Services



SHEET
19 of 22

4-18-14

AJD

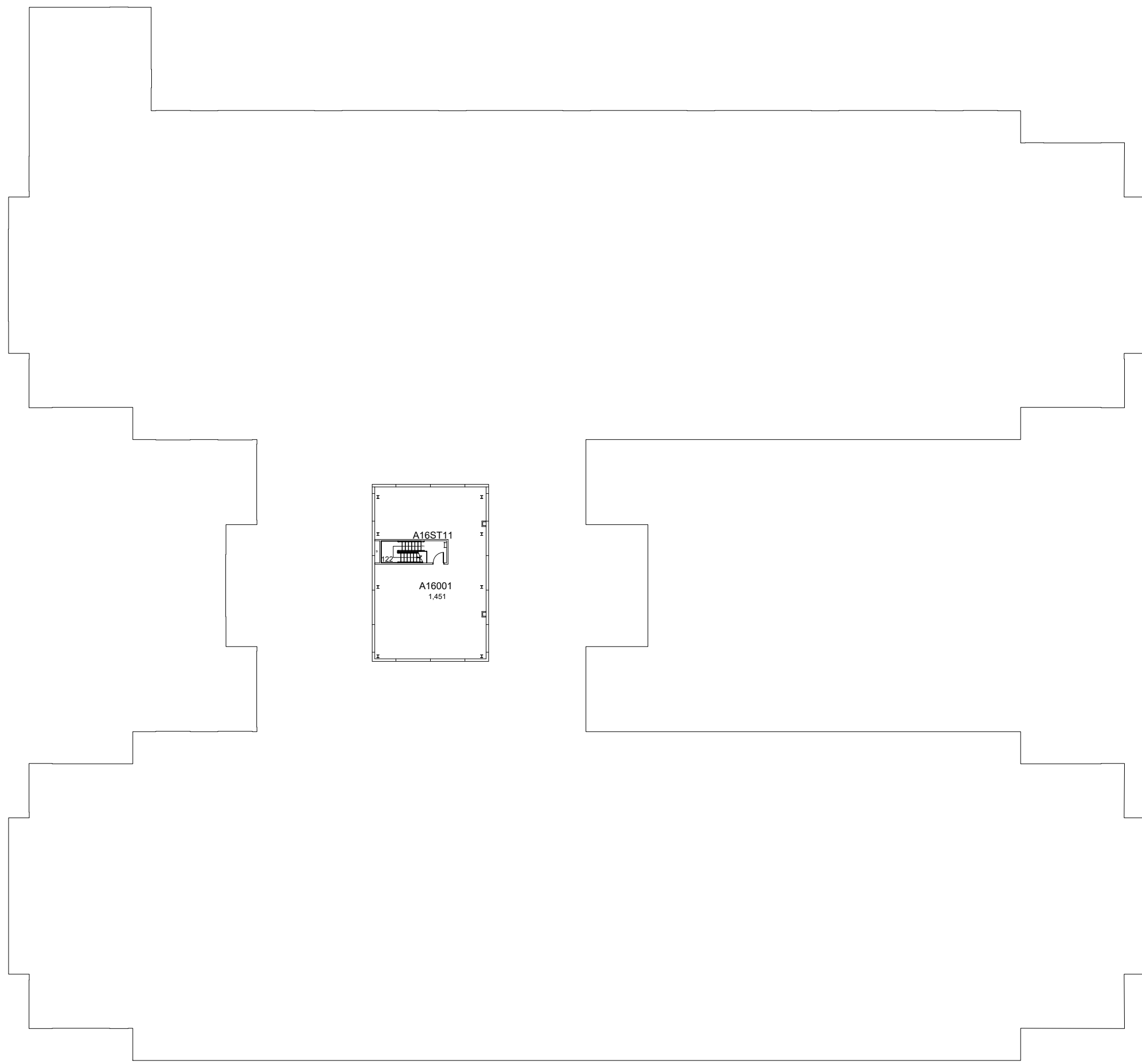

**SIXTEENTH FLOOR PLAN
PATIENT CARE FACILITY (PAVILION A)**

1,732 Gross Square Ft.

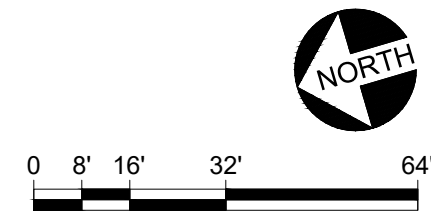

DATE:
MARCH 2010
DRAWN BY:
DB

BLDG #:
0602

PATIENT CARE FACILITY (PAVILION A)
KEY DRAWING

UNIVERSITY OF KENTUCKY
ITS Information Services

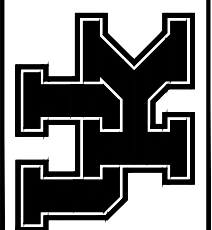

SHEET
20 of 22

4-18-14

AJD

0294
GILL

RF102
1,851

RF303
5,371

RF103
3,780

RF204
1,027

RF205
908

RF202
8,203

RF305
1,098

RF302
4,868

RF304
5,428

RF106
790

RF101
8,152

RF203
3,934

RF301
3,837

RF0201
10,004

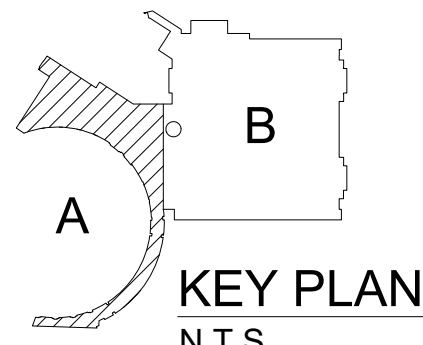

MATCHLINE

ROOF PLAN - A PATIENT CARE FACILITY (PAVILION A)

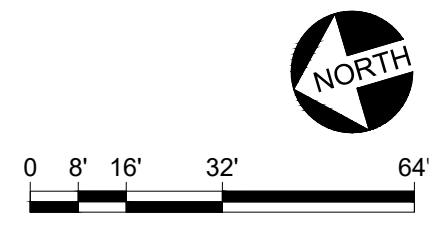

DATE:
MARCH 2010
DRAWN BY:
DB

BLDG #:
0602

PATIENT CARE FACILITY (PAVILION A) KEY DRAWING

UNIVERSITY OF KENTUCKY
ITS Information Services

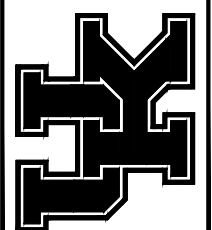

SHEET
21 of 22

4-18-14

AJD

DATE:
MARCH 2010
DRAWN BY:
DB

BLDG #:
0602

PATIENT CARE FACILITY (PAVILION A)

KEY DRAWING

UNIVERSITY OF KENTUCKY
ITS Information Services

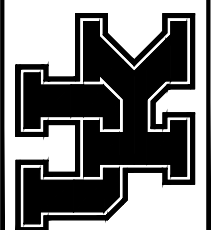

SHEET
22 of 22

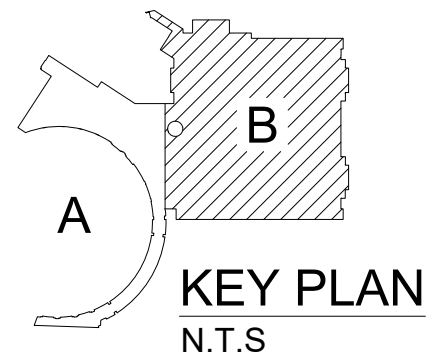
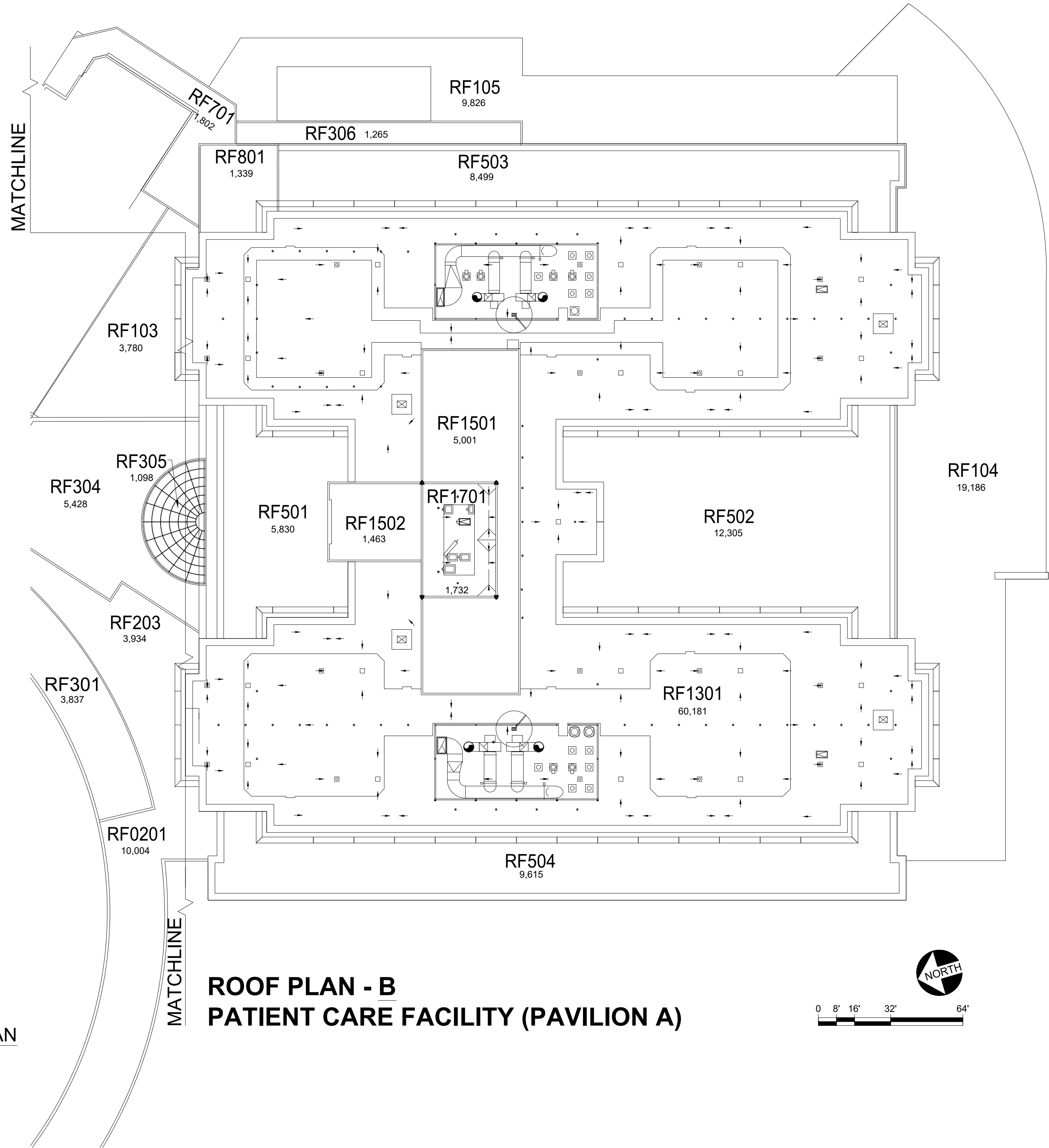

**ROOF PLAN - B
PATIENT CARE FACILITY (PAVILION A)**

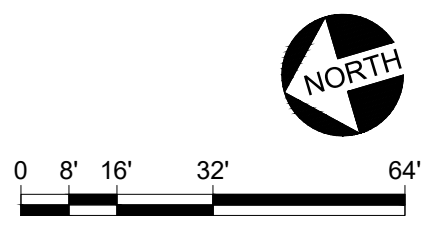

4-18-14

AJD